



TJ

Interval  60 min.  15 min.  
 Binned(CL/SP)  Count(volume)  
Lane No  1  2

---

Direction Channel 1 \_\_\_\_\_  
Direction Channel 2 \_\_\_\_\_  
Unique ID# \_\_\_\_\_

Counter No. 411679 Count ID HPMS  
SR 501 RRT/RRQ MP 0.45  
Leg 1 Direction WB OSID \_\_\_\_\_

Station Description \_ ON SR 501 E/O COLUMBIA ST

Date	Day	Time	Comments				
10-8-12	2	1030	Manual (1) 5 (2) _____ Counter (1) 5 (2)	Set Cntrs	OK	TWB/JDM	6.5
10-9-12	3	1049	Manual (1) 50 (2) _____ Counter (1) 49 (2)	Check Cntrs SP=1	OK	TWB/JDM	6.6
10-10-12	4	0737	Manual (1) 29 (2) _____ Counter (1) 29 (2)	Check Cntrs	OK	TWB/JDM	6.4
10-11-12	5	1015	Manual (1) 23 (2) _____ Counter (1) 22 (2)	Check Cntrs SP=1	OK	TWB/JDM	6.5
10-12-12	6	0743	Manual (1) 1 (2) _____ Counter (1) 1 (2)	P/U Cntrs	OK	TWB/JDM	6.4

Sketch

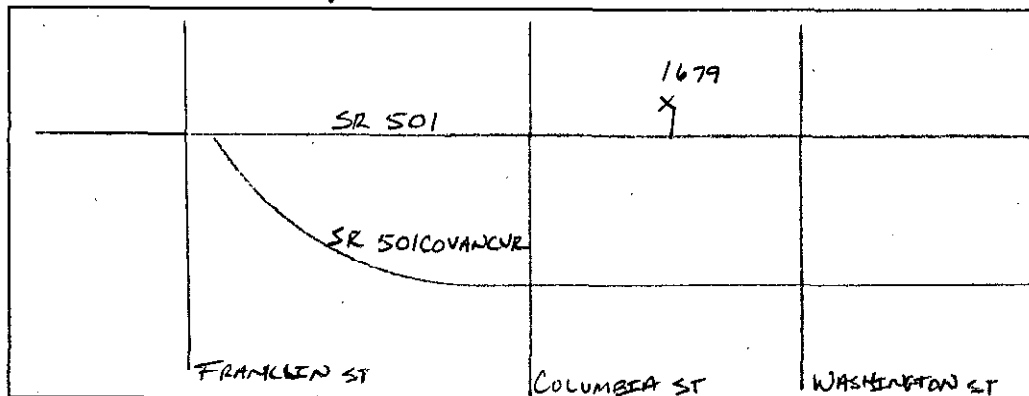

T. BRECKEL  
Field Person

SR 501 MP 000.45 OFF SYSTEM ID. LEG 1 DIRECTION OF TRAFFIC WESTBOUND LANE ALL OF  
 COUNT IDENTIFIER HPMS COUNTER NUMBER 411679 DESCRIPTION: ON SR 501 E/O COLUMBIA ST

10/08/12 MONDAY	AM HOURS												PM HOURS												DAILY TOTAL
	1	2	3	4	5	6	7	8	9	10	11	12	1	2	3	4	5	6	7	8	9	10	11	12	
12	1	2	3	4	5	6	7	8	9	10	11	12	1	2	3	4	5	6	7	8	9	10	11	12	169
TOT	169												494												169
	AM PEAK HOUR 1045 TO 1145 VOLUME 532												AM PEAK HOUR 1215 TO 0115 VOLUME 617												

10/09/12 TUESDAY	AM HOURS												PM HOURS												DAILY TOTAL
	1	2	3	4	5	6	7	8	9	10	11	12	1	2	3	4	5	6	7	8	9	10	11	12	
12	1	2	3	4	5	6	7	8	9	10 <td>11</td> <td>12</td> <td>1</td> <td>2</td> <td>3</td> <td>4</td> <td>5</td> <td>6</td> <td>7</td> <td>8</td> <td>9</td> <td>10</td> <td>11</td> <td>12</td> <td>56</td>	11	12	1	2	3	4	5	6	7	8	9	10	11	12	56
TOT	56												38												56
	AM PEAK HOUR 0745 TO 0845 VOLUME 774												AM PEAK HOUR 1215 TO 0115 VOLUME 678												

10/10/12 WEDNESDAY	AM HOURS												PM HOURS												DAILY TOTAL
	1	2	3	4	5	6	7	8	9	10	11	12	1	2	3	4	5	6	7	8	9	10	11	12	
12	1	2	3	4	5	6	7	8	9	10	11	12	1	2	3	4	5	6	7	8	9	10	11	12	44
TOT	44												41												44
	AM PEAK HOUR 0745 TO 0845 VOLUME 684												AM PEAK HOUR 1230 TO 0130 VOLUME 686												

AM PEAK HOUR 0745 TO 0845 VOLUME 684  
 AM PEAK HOUR 1230 TO 0130 VOLUME 686  
 AM TOTAL 3838  
 PM TOTAL 4369

