



Interval 60 min. 15 min.
 Binned(CL/SP) Count(volume)
Lane No 1 2

Direction Channel 1 _____
Direction Channel 2 _____
Unique ID# _____

Counter No. 427088 Count ID HPMS
SR 503 RRT/RRQ MP 8.09
Leg 2 Direction SB OSID _____

Station Description ON SR 503 N/O W MAIN ST / SR 502

Date	Day	Time	Comments				
10-15-12	2	1223	Manual (1) <u>10</u> (2) _____ Counter (1) <u>10</u> (2) _____	Set Cntrs	OK	TWB/CP	6.4
10-16-12	3	1102	Manual (1) <u>27</u> (2) _____ Counter (1) <u>27</u> (2) _____	Check Cntrs	OK	TWB/CP	6.9
10-17-12	4	0803	Manual (1) <u>50</u> (2) _____ Counter (1) <u>50</u> (2) _____	Check Cntrs	OK	TWB/CP	6.4
10-18-12	5	1047	Manual (1) <u>42</u> (2) _____ Counter (1) <u>42</u> (2) _____	Check Cntrs	OK	TWB/CP	6.9
10-19-12	6	0840	Manual (1) <u>1</u> (2) _____ Counter (1) <u>1</u> (2) _____	P/U Cntrs	OK	TWB/CP	6.4

Sketch

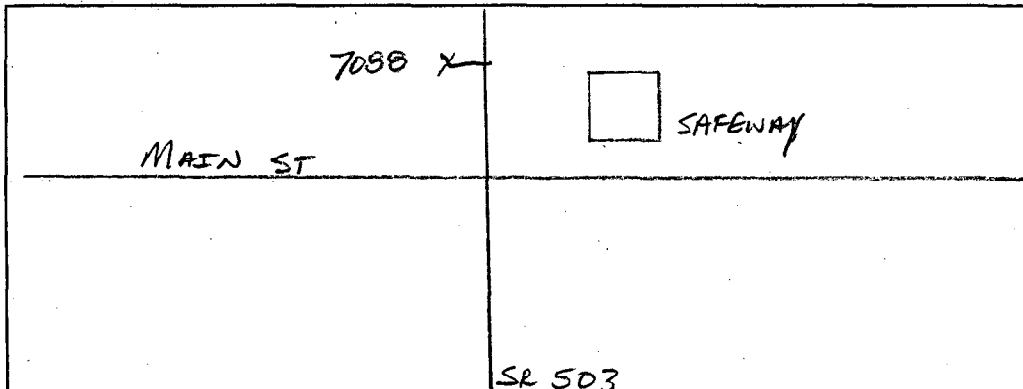

T. BREAUER
Field Person



Interval 60 min. 15 min.
 Binned(CL/SP) Count(volume)
 Lane No 1 2

Direction Channel 1 _____
 Direction Channel 2 _____
 Unique ID# _____

Counter No. 421950 Count ID HPMS
 SR 503 RRT/RRQ MP 8.09
 Leg 2 Direction NB OSID _____

Station Description _ ON SR 503 N/O W MAIN ST / SR 502

Date	Day	Time	Comments				
10-15-12	2	1218	Manual (1) <u>6</u> (2) _____ Counter (1) <u>6</u> (2) _____	Set Cntrs	OK	TWB/CP	6.2
10-16-12	3	1103	Manual (1) <u>23</u> (2) _____ Counter (1) <u>23</u> (2) _____	Check Cntrs	OK	TWB/CP	6.5
10-17-12	4	0803	Manual (1) <u>23</u> (2) _____ Counter (1) <u>23</u> (2) _____	Check Cntrs	OK	TWB/CP	6.3
10-18-12	5	1048	Manual (1) <u>32</u> (2) _____ Counter (1) <u>32</u> (2) _____	Check Cntrs	OK	TWB/CP	7.2
10-19-12	6	0837	Manual (1) <u>1</u> (2) _____ Counter (1) <u>1</u> (2) _____	P/U Cntrs	OK	TWB/CP	6.3

Sketch

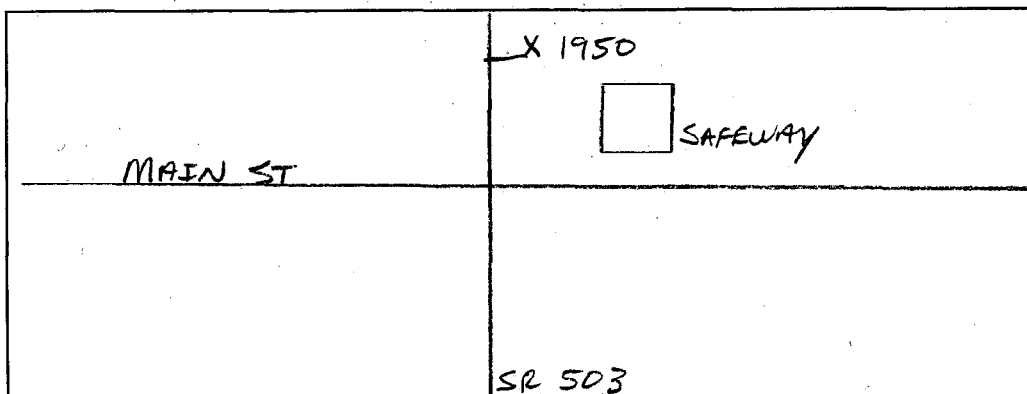

T. BRECKEL
Field Person

SR 503 MP 008.09 OFF SYSTEM ID. LEG 2 DIRECTION OF TRAFFIC SOUTHBOUND LANE ALL OF

COUNT IDENTIFIER HPMS COUNTER NUMBER 427088 DESCRIPTION: ON SR 503 N/O MAIN ST/SR 502

10/15/12	MONDAY												DAILY TOTAL													
	AM HOURS						PM HOURS																			
12	1	2	3	4	5	6	7	8	9	10	11	12	1	2	3	4	5	6	7	8	9	10	11	12		
1	2	3	4	5	6	7	8	9	10	11	12	1	2	3	4	5	6	7	8	9	10	11	12	135		
15-30	5	12	11	12	11	10	9	8	7	6	5	4	3	2	1	0	0	0	0	0	0	0	0	127		
30-45	4	4	4	4	4	4	4	4	4	4	4	4	4	4	4	4	4	4	4	4	4	4	4	137		
45-00	2	2	2	2	2	2	2	2	2	2	2	2	2	2	2	2	2	2	2	2	2	2	2	264		
TOT	15	14	17	17	17	17	17	17	17	17	17	17	17	17	17	17	17	17	17	17	17	17	17	590		
	AM PEAK HOUR 0000 TO 0000 VOLUME												0	AM TOTAL												3933
	PM PEAK HOUR 0345 TO 0445 VOLUME												590	PM TOTAL												3933

10/16/12	TUESDAY												DAILY TOTAL													
	AM HOURS						PM HOURS																			
12	1	2	3	4	5	6	7	8	9	10	11	12	1	2	3	4	5	6	7	8	9	10	11	12		
1	2	3	4	5	6	7	8	9	10	11	12	1	2	3	4	5	6	7	8	9	10	11	12	188		
15-30	5	5	5	5	5	5	5	5	5	5	5	5	5	5	5	5	5	5	5	5	5	5	5	127		
30-45	4	4	4	4	4	4	4	4	4	4	4	4	4	4	4	4	4	4	4	4	4	4	4	173		
45-00	3	3	3	3	3	3	3	3	3	3	3	3	3	3	3	3	3	3	3	3	3	3	3	206		
TOT	17	20	20	20	20	20	20	20	20	20	20	20	20	20	20	20	20	20	20	20	20	20	20	644		
	AM PEAK HOUR 0715 TO 0815 VOLUME												1000	AM TOTAL												4983
	PM PEAK HOUR 0200 TO 0300 VOLUME												644	PM TOTAL												4379

10/17/12	WEDNESDAY												DAILY TOTAL													
	AM HOURS						PM HOURS																			
12	1	2	3	4	5	6	7	8	9	10	11	12	1	2	3	4	5	6	7	8	9	10	11	12		
1	2	3	4	5	6	7	8	9	10	11	12	1	2	3	4	5	6	7	8	9	10	11	12	224		
15-30	5	5	5	5	5	5	5	5	5	5	5	5	5	5	5	5	5	5	5	5	5	5	5	127		
30-45	4	4	4	4	4	4	4	4	4	4	4	4	4	4	4	4	4	4	4	4	4	4	4	178		
45-00	2	2	2	2	2	2	2	2	2	2	2	2	2	2	2	2	2	2	2	2	2	2	2	130		
TOT	15	14	17	17	17	17	17	17	17	17	17	17	17	17	17	17	17	17	17	17	17	17	17	609		
	AM PEAK HOUR 0700 TO 0800 VOLUME												895	AM TOTAL												4684
	PM PEAK HOUR 0415 TO 0515 VOLUME												658	PM TOTAL												4548

DOT-RNB515A-B

STATE OF WASHINGTON - DEPARTMENT OF TRANSPORTATION
TRIP SYSTEM
15 MINUTE TRAFFIC COUNT SUMMARY

DATE 10/23/12
TIME 07:21:59
PAGE 86

SR 503 MP 008.09 OFF SYSTEM ID. LEG 2 DIRECTION OF TRAFFIC SOUTHBOUND LANE ALL OF

COUNT IDENTIFIER HPMS COUNTER NUMBER 427088 DESCRIPTION: ON SR 503 N/O MAIN ST/SR 502

10/18/12 THURSDAY	AM HOURS												PM HOURS												DAILY TOTAL
	1	2	3	4	5	6	7	8	9	10	11	12	1	2	3	4	5	6	7	8	9	10	11	12	
12	1	2	3	4	5	6	7	8	9	10	11	12	1	2	3	4	5	6	7	8	9	10	11	12	9435
TOT	14	14	22	54	139	435	768	978	735	648	515	489	507	502	539	567	640	619	457	287	180	176	109	41	
	AM PEAK HOUR 0715 TO 0815 VOLUME 1003												PM PEAK HOUR 0445 TO 0545 VOLUME 675												AM TOTAL 4811
																									PM TOTAL 4624

10/19/12 FRIDAY	AM HOURS												PM HOURS												DAILY TOTAL
	1	2	3	4	5	6	7	8	9	10	11	12	1	2	3	4	5	6	7	8	9	10	11	12	
12	1	2	3	4	5	6	7	8	9	10	11	12	1	2	3	4	5	6	7	8	9	10	11	12	2704
TOT	27	14	24	50	123	409	703	911	443																
	AM PEAK HOUR 0715 TO 0815 VOLUME 974												PM PEAK HOUR 0000 TO 0000 VOLUME 0												AM TOTAL 2704
																									PM TOTAL 0

10/15/12 THRU 10/19/12 TOTAL HOURS FOR COUNT 91

3 DAYS AVG WEEKDAY VOL 9343 X SEASONAL ADJ. FACTOR 0.9400 = 8782 X AXLE CORR FACTOR 0.9462 = ESTIMATED AVG DAILY TRAFFIC 8310

FACTOR GROUP GR-02

FACTOR GROUP GR-A2

SR 503 MP 008.09 OFF SYSTEM ID. LEG 2 DIRECTION OF TRAFFIC NORTHBOUND LANE ALL OF

COUNT IDENTIFIER HPMS COUNTER NUMBER 421950 DESCRIPTION: ON SR 503 N/O MAIN ST/SR 502

COUNT IDENTIFIER	HPMS	COUNTER NUMBER	AM HOURS												AM TOTAL	PM HOURS												PM TOTAL	DAILY TOTAL
			1	2	3	4	5	6	7	8	9	10	11	12		1	2	3	4	5	6	7	8	9	10	11	12		
10/15/12 MONDAY			1	2	3	4	5	6	7	8	9	10	11	12	1	2	3	4	5	6	7	8	9	10	11	12	0	6302	
00-15																													
15-30			1	2	3	4	5	6	7	8	9	10	11	12	132	171	202	187	230	201	105	118	77	70	53	32	112	128	
30-45															127	174	222	243	273	190	98	114	70	42	22	128	172		
45-00															158	225	195	277	142	110	77	68	30	24	128	172			
TOT			240	526	648	861	814	1009	743	481	415	289	175	101	240	526	648	861	814	1009	743	481	415	289	175	101	0	6302	

AM PEAK HOUR 0000 TO 0000 VOLUME 0
PM PEAK HOUR 0500 TO 0600 VOLUME 1009

COUNT IDENTIFIER	HPMS	COUNTER NUMBER	AM HOURS												AM TOTAL	PM HOURS												PM TOTAL	DAILY TOTAL
			1	2	3	4	5	6	7	8	9	10	11	12		1	2	3	4	5	6	7	8	9	10	11	12		
10/16/12 TUESDAY			1	2	3	4	5	6	7	8	9	10	11	12	1	2	3	4	5	6	7	8	9	10	11	12	0	9089	
00-15																													
15-30			1	2	3	4	5	6	7	8	9	10	11	12	50	68	89	95	89	89	134	149	139	162	181	193	112	142	
30-45															92	98	122	112	175	183	200	241	284	203	121	97	142		
45-00															85	85	95	105	133	176	201	204	243	267	162	85	142		
TOT			369	359	338	449	516	602	700	778	869	988	775	531	369	359	338	449	516	602	700	778	869	988	775	531	0	9089	

AM PEAK HOUR 1100 TO 1200 VOLUME 449
PM PEAK HOUR 0500 TO 0600 VOLUME 988

COUNT IDENTIFIER	HPMS	COUNTER NUMBER	AM HOURS												AM TOTAL	PM HOURS												PM TOTAL	DAILY TOTAL
			1	2	3	4	5	6	7	8	9	10	11	12		1	2	3	4	5	6	7	8	9	10	11	12		
10/17/12 WEDNESDAY			1	2	3	4	5	6	7	8	9	10	11	12	1	2	3	4	5	6	7	8	9	10	11	12	0	8870	
00-15																													
15-30			1	2	3	4	5	6	7	8	9	10	11	12	19	23	46	89	68	61	103	124	103	132	201	254	111	252	
30-45															87	87	90	79	84	96	130	124	178	216	238	89	252		
45-00															68	68	109	64	109	108	116	127	181	207	229	109	252		
TOT			399	283	333	388	462	479	637	839	934	959	864	621	399	283	333	388	462	479	637	839	934	959	864	621	0	8870	

AM PEAK HOUR 0800 TO 0900 VOLUME 399
PM PEAK HOUR 0445 TO 0545 VOLUME 963

SR 503 MP 008.09 OFF SYSTEM ID. LEG 2 DIRECTION OF TRAFFIC NORTHBOUND LANE ALL OF

COUNT IDENTIFIER	HPMS	COUNTER NUMBER	421950	DESCRIPTION: ON SR 503 N/O MAIN ST/SR 502	AM PEAK HOUR 0730 TO 0830 VOLUME	PM PEAK HOUR 0500 TO 0600 VOLUME	AM TOTAL	PM TOTAL	DAILY TOTAL																
10/18/12 THURSDAY																									
12	1	2	3	4	5	6	7	8	9	10	11	12	DAILY TOTAL												
	1	2	3	4	5	6	7	8	9	10	11	12													
00-15	24	14	3	5	5	12	14	48	111	96	103	114	100	161	211	188	250	207	201	127	107	47	30		
15-30	18	10	12	6	5	12	23	52	95	69	82	103	135	127	193	240	213	231	214	159	119	102	59	26	
30-45	18	9	6	16	2	4	32	116	85	90	93	113	134	152	253	222	234	194	134	110	106	53	36		
45-00	16	5	2	4	8	11	27	143	86	78	95	103	151	182	205	224	247	270	202	117	77	50	33		
TOT	76	38	23	17	20	39	96	359	377	333	366	422	534	552	711	908	870	985	817	611	465	392	209	125	9345

10/19/12 FRIDAY	AM HOURS	PM HOURS	AM PEAK HOUR 0730 TO 0830 VOLUME	PM PEAK HOUR 0000 TO 0000 VOLUME	AM TOTAL	PM TOTAL	DAILY TOTAL						
12	1	2	3	4	5	6	7	8	9	10	11	12	DAILY TOTAL
	1	2	3	4	5	6	7	8	9	10	11	12	
00-15	27	12	1	7	3	7	12	44	105				105
15-30	22	12	8	2	3	6	32	62	96				96
30-45	21	6	8	2	6	10	24	100					100
45-00	16	9	6	2	6	14	30	141					141
TOT	86	39	23	11	18	37	98	347	201				860

10/15/12 THRU 10/19/12 TOTAL HOURS FOR COUNT 91

3 DAYS AVG WEEKDAY VOL 9101 X SEASONAL ADJ. FACTOR 0.9400 = 8555 X AXLE CORR FACTOR 0.9462 = ESTIMATED AVG DAILY TRAFFIC 8095

FACTOR GROUP GR-02
FACTOR GROUP GR-A2

SR 503 MP 008.09 OFF SYSTEM ID. LEG 2 DIRECTION OF TRAFFIC BOTH WAYS LANE ALL OF
COUNT IDENTIFIER HPMS COUNTER NUMBER 421950 DESCRIPTION: ON SR 503 N/O MAIN ST/SR 502

HOUR	10/15/12 MONDAY												DAILY TOTAL	
	1	2	3	4	5	6	7	8	9	10	11	12		
00-15														
15-30	12	1	2	3	4	5	6	7	8	9	10	11	12	
30-45	1	2	3	4	5	6	7	8	9	10	11	12		
45-00														
TOT														
	AM HOURS													
	PM HOURS													
	504 1030 1224 1383 1385 1460 1135 711 620 411 243 129 10235													
	AM PEAK HOUR 0000 TO 0000 VOLUME 0													
	PM PEAK HOUR 0515 TO 0615 VOLUME 1463													

HOUR	10/16/12 TUESDAY												DAILY TOTAL	
	1	2	3	4	5	6	7	8	9	10	11	12		
00-15														
15-30	36	14	14	12	29	80	182	238	310	273	222	213	258	239
30-45	20	17	8	11	42	108	226	316	255	262	231	267	272	281
45-00	33	17	11	17	40	151	263	336	265	245	225	240	240	300
TOT	102	59	37	53	170	474	924	1341	1133	1043	916	953	1043	1122
	AM HOURS													
	PM HOURS													
	AM PEAK HOUR 0715 TO 0815 VOLUME 1413													
	PM PEAK HOUR 0445 TO 0545 VOLUME 1506													

HOUR	10/17/12 WEDNESDAY												DAILY TOTAL	
	1	2	3	4	5	6	7	8	9	10	11	12		
00-15														
15-30	27	17	11	17	27	82	198	275	320	231	215	217	228	234
30-45	22	16	6	13	39	124	218	254	284	221	193	213	213	261
45-00	21	8	9	16	37	143	242	321	268	246	189	215	259	251
TOT	82	45	37	69	156	483	880	1147	1160	892	800	890	951	1000
	AM HOURS													
	PM HOURS													
	AM PEAK HOUR 0730 TO 0830 VOLUME 1222													
	PM PEAK HOUR 0445 TO 0545 VOLUME 1612													

STATE OF WASHINGTON - DEPARTMENT OF TRANSPORTATION
TRIP SYSTEM
15 MINUTE TRAFFIC COUNT SUMMARY

SR 503 MP 008.09 OFF SYSTEM ID. LEG 2 DIRECTION OF TRAFFIC BOTH WAYS LANE ALL OF

COUNT IDENTIFIER HPMS COUNTER NUMBER 421950 DESCRIPTION: ON SR 503 N/O MAIN ST/SR 502

COUNT	IDENTIFIER	HPMS	AM HOURS												DAILY TOTAL												
			1	2	3	4	5	6	7	8	9	10	11	12													
10/18/12	THURSDAY		1	2	3	4	5	6	7	8	9	10	11	12	1	2	3	4	5	6	7	8	9	10	11	12	18780
TOT			90	52	45	71	159	474	864	1337	1112	981	881	911	1041	1054	1250	1475	1510	1604	1274	898	645	568	318	166	6977

COUNT	IDENTIFIER	HPMS	AM HOURS												DAILY TOTAL												
			1	2	3	4	5	6	7	8	9	10	11	12													
10/19/12	FRIDAY		1	2	3	4	5	6	7	8	9	10	11	12	1	2	3	4	5	6	7	8	9	10	11	12	3564
TOT			113	53	47	61	141	446	801	1258	644																1398

10/15/12 THRU 10/19/12 TOTAL HOURS FOR COUNT 91

3 DAYS AVG WEEKDAY VOL 18444 X SEASONAL ADJ. FACTOR 0.9400 = 17337 X AXLE CORR FACTOR 0.9462 = ESTIMATED AVG DAILY TRAFFIC 16404

PEAK HOUR PERCENTAGES: K = 8.88 D = 58.77
 PEAK HOUR LOCATION : VOLUME = 1637 DATE: 10/18/12 TIME: 04:45 PM



Interval 60 min. 15 min.
 Binned(CL/SP) Count(volume)
Lane No 1 2

Direction Channel 1 _____
Direction Channel 2 _____
Unique ID# _____

Counter No. 428682 Count ID HPMS
SR 503 RRT/RRQ _____ MP 8.09
Leg 1 Direction SB OSID _____

Station Description ON SR 503 S/O W MAIN ST / SR 502

Date	Day	Time	Comments				
10-15-12	2	1208	Manual (1) <u>7</u> (2) _____ Counter (1) <u>7</u> (2) _____	Set Cntrs	OK	TWB/CP	6.4
10-16-12	3	1111	Manual (1) <u>50</u> (2) _____ Counter (1) <u>50</u> (2) _____	Check Cntrs	OK	TWB/CP	6.7
10-17-12	4	0810	Manual (1) <u>50</u> (2) _____ Counter (1) <u>50</u> (2) _____	Check Cntrs	OK	TWB/CP	6.3
10-18-12	5	1056	Manual (1) <u>50</u> (2) _____ Counter (1) <u>49</u> (2) _____	Check Cntrs SP=1	OK	TWB/CP	6.7
10-19-12	6	0853	Manual (1) <u>1</u> (2) _____ Counter (1) <u>1</u> (2) _____	P/U Cntrs	OK	TWB/CP	6.4

Sketch

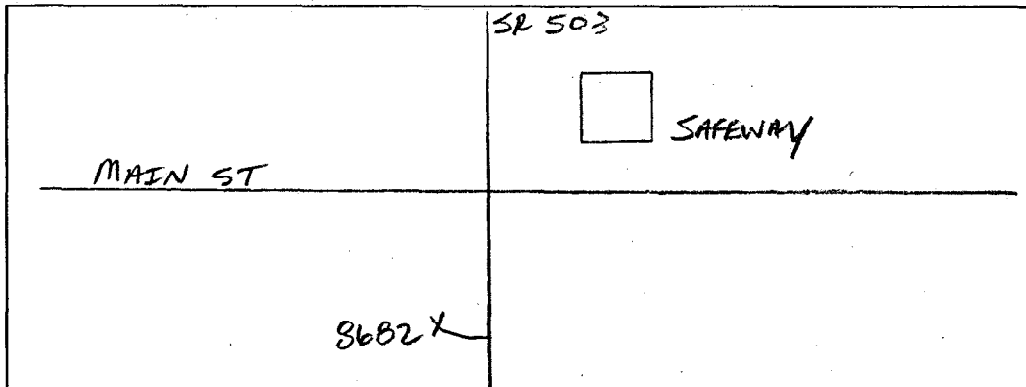

North

T. BRECKEL

Field Person



Interval 60 min. 15 min.
 Binned(CL/SP) Count(volume)
Lane No 1 2

Direction Channel 1 _____
Direction Channel 2 _____
Unique ID# _____

Counter No. 427087 Count ID HPMS
SR 503 RRT/RRQ _____ MP 8.09
Leg 1 Direction NB OSID _____

Station Description _ ON SR 503 S/O W MAIN ST / SR 502

Date	Day	Time	Comments				
10-15-12	2	1204	Manual (1) <u>10</u> (2) _____ Counter (1) <u>10</u> (2) _____	Set Cntrs	OK	TWB/CP	6.4
10-16-12	3	1111	Manual (1) <u>33</u> (2) _____ Counter (1) <u>32</u> (2) _____	Check Cntrs SP=1	OK	TWB/CP	6.7
10-17-12	4	0811	Manual (1) <u>30</u> (2) _____ Counter (1) <u>29</u> (2) _____	Check Cntrs SP=1	OK	TWB/CP	6.4
10-18-12	5	1056	Manual (1) <u>40</u> (2) _____ Counter (1) <u>39</u> (2) _____	Check Cntrs SP=1	OK	TWB/CP	7.1
10-19-12	6	0830	Manual (1) <u>1</u> (2) _____ Counter (1) <u>1</u> (2) _____	P/U Cntrs	OK	TWB/CP	6.4

Sketch

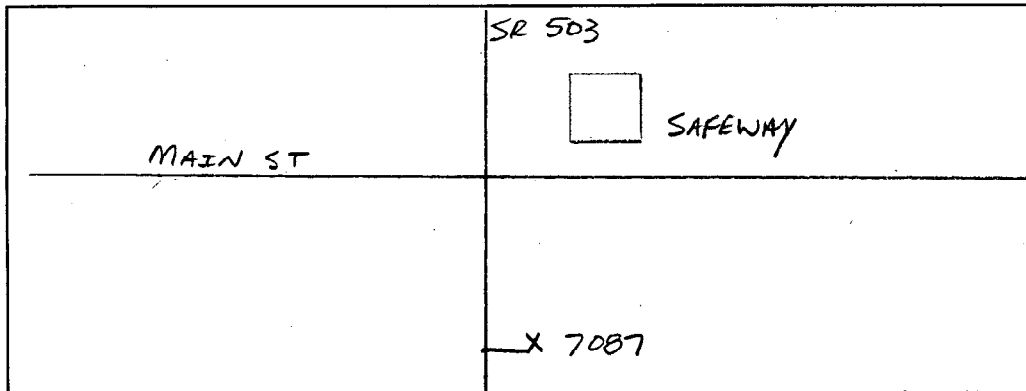

T. BREUER
Field Person

10/15/12 MONDAY	AM HOURS	PM HOURS	AM TOTAL	PM TOTAL	DAILY TOTAL								
12	1	2	3	4	5	6	7	8	9	10	11	12	TOTAL
1	2	3	4	5	6	7	8	9	10	11	12	TOTAL	5597
00-15	177	195	215	170	161	172	169	120	81	92	37	15	
15-30	154	154	178	186	202	162	137	99	75	50	20	18	
30-45	159	174	173	155	166	145	136	76	78	56	21	25	
45-00	169	182	186	162	175	147	103	82	76	38	17	11	
HOUR	505	705	752	673	704	626	545	377	310	236	95	69	5597
TOT	AM PEAK HOUR 0000 TO 0000 VOLUME 0												0
	PM PEAK HOUR 0200 TO 0300 VOLUME 752												752

10/16/12 TUESDAY	AM HOURS	PM HOURS	AM TOTAL	PM TOTAL	DAILY TOTAL																				
12	1	2	3	4	5	6	7	8	9	10	11	12	TOTAL												
1	2	3	4	5	6	7	8	9	10	11	12	TOTAL	5462												
00-15	7	5	6	10	25	64	181	222	258	196	174	149	173	175	188	179	178	181	159	109	81	73	38	17	
15-30	12	6	7	15	35	91	198	289	202	177	169	161	194	145	212	170	201	174	127	87	64	71	38	17	
30-45	8	7	10	13	47	131	249	227	181	177	163	171	162	180	179	186	171	134	74	70	47	29	10	10	
45-00	7	4	4	15	53	124	216	267	186	204	171	168	163	142	163	153	157	165	136	67	70	30	23	12	
HOUR	34	22	27	53	160	410	844	1005	827	754	677	649	692	642	742	707	722	691	556	337	285	221	128	56	11241
TOT	AM PEAK HOUR 0715 TO 0815 VOLUME 1041												1041												
	PM PEAK HOUR 0200 TO 0300 VOLUME 742												742												

10/17/12 WEDNESDAY	AM HOURS	PM HOURS	AM TOTAL	PM TOTAL	DAILY TOTAL																				
12	1	2	3	4	5	6	7	8	9	10	11	12	TOTAL												
1	2	3	4	5	6	7	8	9	10	11	12	TOTAL	5147												
00-15	13	5	3	13	24	66	167	242	187	188	154	149	168	174	127	192	203	201	161	143	84	103	28	24	
15-30	12	6	4	19	33	107	210	232	212	177	176	149	174	157	161	159	200	190	136	117	58	75	34	26	
30-45	5	8	3	11	27	115	240	242	201	196	140	138	171	157	197	179	172	165	156	74	71	49	28	16	
45-00	8	6	8	21	41	130	191	224	177	149	145	173	161	147	148	163	192	147	155	69	126	39	18	17	
HOUR	38	25	18	64	125	418	808	940	777	710	615	609	674	635	633	693	767	703	608	403	339	266	108	83	11059
TOT	AM PEAK HOUR 0700 TO 0800 VOLUME 940												940												
	PM PEAK HOUR 0400 TO 0500 VOLUME 767												767												

DOT-RNB515A-B

STATE OF WASHINGTON - DEPARTMENT OF TRANSPORTATION
TRIP SYSTEM
15 MINUTE TRAFFIC COUNT SUMMARY

DATE 10/23/12
TIME 07:21:59
PAGE 80

SR 503 MP 008.09 OFF SYSTEM ID. LEG 1 DIRECTION OF TRAFFIC SOUTHBOUND LANE ALL OF

COUNT IDENTIFIER HPMS COUNTER NUMBER 428682 DESCRIPTION: ON SR 503 S/O MAIN ST/SR 502

10/18/12 THURSDAY	AM HOURS												PM HOURS												DAILY TOTAL
	1	2	3	4	5	6	7	8	9	10	11	12	1	2	3	4	5	6	7	8	9	10	11	12	
12	1	2	3	4	5	6	7	8	9	10	11	12	1	2	3	4	5	6	7	8	9	10	11	12	114
37	26	31	55	140	405	806	1008	804	702	640	621	667	664	691	692	795	830	620	433	307	262	156	86	11478	
AM PEAK HOUR 0715 TO 0815 VOLUME 1014												PM PEAK HOUR 0445 TO 0545 VOLUME 877												AM TOTAL 5275	
PM PEAK HOUR 0445 TO 0545 VOLUME 877																								PM TOTAL 6203	

10/19/12 FRIDAY	AM HOURS												PM HOURS												DAILY TOTAL
	1	2	3	4	5	6	7	8	9	10	11	12	1	2	3	4	5	6	7	8	9	10	11	12	
12	1	2	3	4	5	6	7	8	9	10	11	12	1	2	3	4	5	6	7	8	9	10	11	12	2805
44	27	26	55	130	363	738	946	476																2805	
AM PEAK HOUR 0730 TO 0830 VOLUME 993												PM PEAK HOUR 0000 TO 0000 VOLUME 0												AM TOTAL 2805	
PM PEAK HOUR 0000 TO 0000 VOLUME 0																								PM TOTAL 0	

10/15/12 THRU 10/19/12
TOTAL HOURS FOR COUNT 91

3 DAYS
AVG WEEKDAY VOL 11259 X SEASONAL ADJ. FACTOR 0.9400 = 10583 X AXLE CORR FACTOR 0.9462 = ESTIMATED AVG DAILY TRAFFIC 10014

FACTOR GROUP GR-02

FACTOR GROUP GR-A2

SR 503 MP 008.09 OFF SYSTEM ID. LEG 1 DIRECTION OF TRAFFIC NORTHBOUND LANE ALL OF

COUNT IDENTIFIER HPMS COUNTER NUMBER 427087 DESCRIPTION: ON SR 503 S/O MAIN ST/SR 502

10/15/12	MONDAY												DAILY TOTAL
	AM HOURS												
	1	2	3	4	5	6	7	8	9	10	11	12	
00-15	1	2	3	4	5	6	7	8	9	10	11	12	147
15-30	1	2	3	4	5	6	7	8	9	10	11	12	150
30-45	1	2	3	4	5	6	7	8	9	10	11	12	157
45-00	1	2	3	4	5	6	7	8	9	10	11	12	175
TOT	4	8	12	16	20	24	28	32	36	40	44	48	482
	AM PEAK HOUR 0000 TO 0000 VOLUME 0												AM TOTAL 0
	PM PEAK HOUR 0500 TO 0600 VOLUME 1179												PM TOTAL 7834

10/16/12	TUESDAY												DAILY TOTAL
	AM HOURS												
	1	2	3	4	5	6	7	8	9	10	11	12	
00-15	1	2	3	4	5	6	7	8	9	10 <td>118</td>	118		
15-30	1	2	3	4	5	6	7	8	9	10 <td>143</td>	143		
30-45	1	2	3	4	5	6	7	8	9	10 <td>155</td>	155		
45-00	1	2	3	4	5	6	7	8	9	10 <td>164</td>	164		
TOT	4	8	12	16	20	24	28	32	36	40	44	48	562
	AM PEAK HOUR 0730 TO 0830 VOLUME 643												AM TOTAL 3445
	PM PEAK HOUR 0445 TO 0545 VOLUME 1172												PM TOTAL 8108

10/17/12	WEDNESDAY												DAILY TOTAL
	AM HOURS												
	1	2	3	4	5	6	7	8	9	10	11	12	
00-15	1	2	3	4	5	6	7	8	9	10 <td>140</td>	140		
15-30	1	2	3	4	5	6	7	8	9	10 <td>131</td>	131		
30-45	1	2	3	4	5	6	7	8	9	10 <td>135</td>	135		
45-00	1	2	3	4	5	6	7	8	9	10 <td>176</td>	176		
TOT	4	8	12	16	20	24	28	32	36	40	44	48	581
	AM PEAK HOUR 0800 TO 0900 VOLUME 581												AM TOTAL 3162
	PM PEAK HOUR 0445 TO 0545 VOLUME 1162												PM TOTAL 8275

DOT-RNB515A-8

STATE OF WASHINGTON - DEPARTMENT OF TRANSPORTATION
TRIP SYSTEM
15 MINUTE TRAFFIC COUNT SUMMARY

DATE 10/23/12
TIME 07:21:59
PAGE 82

SR 503 MP 008.09 OFF SYSTEM ID. LEG 1 DIRECTION OF TRAFFIC NORTHBOUND LANE ALL OF

COUNT IDENTIFIER	HPMS	COUNTER NUMBER	427087	DESCRIPTION: ON SR 503 S/O MAIN ST/SR 502	AM PEAK HOUR 0730 TO 0830 VOLUME	PM PEAK HOUR 0445 TO 0545 VOLUME	AM TOTAL	PM TOTAL	DAILY TOTAL															
10/18/12 THURSDAY					674	1186	3285	8568	11853															
12	1	2	3	4	5	6	7	8	9	10	11	12	DAILY TOTAL											
	1	2	3	4	5	6	7	8	9	10	11	12												
00-15	26	19	5	5	19	32	88	160	128	113	138	171	150	217	235	243	305	262	201	137	126	54	42	
15-30	14	12	17	9	9	23	48	150	123	127	130	196	160	238	305	278	274	223	154	122	122	64	31	
30-45	18	13	5	6	15	17	68	137	114	133	172	195	173	220	273	252	306	223	161	127	93	50	41	
45-00	20	9	10	10	27	26	72	149	118	123	149	179	194	249	316	301	253	254	133	102	80	48	35	
TOT	78	53	37	30	57	85	220	596	483	496	589	741	677	924	1129	1074	1138	962	649	488	421	216	149	11853

10/19/12 FRIDAY	AM HOURS	PM HOURS	AM PEAK HOUR 0715 TO 0815 VOLUME	PM PEAK HOUR 0000 TO 0000 VOLUME	AM TOTAL	PM TOTAL	DAILY TOTAL						
12	1	2	3	4	5	6	7	8	9	10	11	12	DAILY TOTAL
	1	2	3	4	5	6	7	8	9	10	11	12	
00-15	32	16	5	9	8	20	24	80	125	121	125	125	125
15-30	24	14	10	2	9	31	53	145	121	121	121	121	121
30-45	16	14	12	9	14	27	74	159	121	121	121	121	121
45-00	16	9	7	7	19	41	81	180	121	121	121	121	121
TOT	88	53	34	27	50	119	232	564	246	609	0	1413	1413

3 DAYS
 AVG WEEKDAY VOL 11614 X SEASONAL ADJ. FACTOR 0.9400 = 10917 X AXLE CORR FACTOR 0.9462 = ESTIMATED AVG DAILY TRAFFIC 10330

SR 503 MP 008.09 OFF SYSTEM ID. LEG 1 DIRECTION OF TRAFFIC BOTH WAYS LANE ALL OF
 COUNT IDENTIFIER HPMS COUNTER NUMBER 427087 DESCRIPTION: ON SR 503 S/O MAIN ST/SR 502

10/15/12 MONDAY	AM HOURS												PM HOURS												DAILY TOTAL
	1	2	3	4	5	6	7	8	9	10	11	12	1	2	3	4	5	6	7	8	9	10	11	12	
12	1	2	3	4	5	6	7	8	9	10	11	12	1	2	3	4	5	6	7	8	9	10	11	12	13431
TOT	987												1396 1619 1729 1773 1805 1414 909 745 589 283 182 13431												
	AM PEAK HOUR 0000 TO 0000 VOLUME 0												PM PEAK HOUR 0415 TO 0515 VOLUME 1815												

10/16/12 TUESDAY	AM HOURS												PM HOURS												DAILY TOTAL
	1	2	3	4	5	6	7	8	9	10	11	12	1	2	3	4	5	6	7	8	9	10	11	12	
12	1	2	3	4	5	6	7	8	9	10	11	12	1	2	3	4	5	6	7	8	9	10	11	12	22794
TOT	133												69 52 86 203 515 1122 1592 1389 1277 1194 1275 1413 1375 1559 1678 1745 1848 1416 904 814 629 309 197 22794												
	AM PEAK HOUR 0715 TO 0815 VOLUME 1668												PM PEAK HOUR 0445 TO 0545 VOLUME 1855												

10/17/12 WEDNESDAY	AM HOURS												PM HOURS												DAILY TOTAL
	1	2	3	4	5	6	7	8	9	10	11	12	1	2	3	4	5	6	7	8	9	10	11	12	
12	1	2	3	4	5	6	7	8	9	10	11	12	1	2	3	4	5	6	7	8	9	10	11	12	14187
TOT	123												58 52 95 172 495 1043 1400 1358 1188 1135 1190 1387 1316 1456 1679 1858 1846 1528 1105 810 668 309 225 22496												
	AM PEAK HOUR 0730 TO 0830 VOLUME 1413												PM PEAK HOUR 0430 TO 0530 VOLUME 1912												

DOT-RNB515A-B

STATE OF WASHINGTON - DEPARTMENT OF TRANSPORTATION
TRIP SYSTEM
15 MINUTE TRAFFIC COUNT SUMMARY

DATE 10/23/12
TIME 07:21:59
PAGE 84

SR 503 MP 008.09 OFF SYSTEM ID. LEG 1 DIRECTION OF TRAFFIC BOTH WAYS LANE ALL OF

COUNT IDENTIFIER	HPMS	COUNTER NUMBER	427087	DESCRIPTION: ON SR 503 S/O MAIN ST/SR 502	AM PEAK HOUR 0715 TO 0815 VOLUME	PM PEAK HOUR 0445 TO 0545 VOLUME	AM TOTAL	PM TOTAL	DAILY TOTAL																
10/18/12 THURSDAY																									
12	1	2	3	4	5	6	7	8	9	10	11	DAILY TOTAL													
	1	2	3	4	5	6	7	8	9	10	11														
00-15	38	26	10	17	38	82	200	324	402	319	286	319	318	326	406	432	456	553	421	328	250	197	105	66	
15-30	21	21	27	21	35	113	235	375	347	305	273	294	315	414	467	456	486	516	380	272	166	205	101	53	
30-45	25	19	12	25	55	138	320	417	324	279	312	377	342	399	438	449	516	380	248	189	159	87	61		
45-00	31	13	19	22	69	157	271	453	327	282	285	342	358	396	484	508	413	395	234	190	122	79	55		
TOT	115	79	68	85	197	490	1026	1569	1400	1185	1136	1210	1408	1341	1615	1821	1869	1968	1582	1082	795	683	372	235	23331

10/19/12 FRIDAY	AM HOURS	PM HOURS	AM PEAK HOUR 0715 TO 0815 VOLUME	PM PEAK HOUR 0000 TO 0000 VOLUME	AM TOTAL	PM TOTAL	DAILY TOTAL					
12	1	2	3	4	5	6	7	8	9	10	11	DAILY TOTAL
	1	2	3	4	5	6	7	8	9	10	11	
00-15	45	20	10	20	38	73	171	290	368			368
15-30	32	21	14	16	27	113	249	364	354			354
30-45	28	22	24	23	54	126	268	427				
45-00	27	17	12	23	61	170	282	429				
TOT	132	80	60	82	180	482	970	1510	722			4218

10/15/12 THRU 10/19/12 91
 3 DAYS
 AVG WEEKDAY VOL 22874 X SEASONAL ADJ. FACTOR 0.9400 = 21502 X AXLE CORR FACTOR 0.9462 = ESTIMATED AVG DAILY TRAFFIC 20345
 PEAK HOUR PERCENTAGES: K = 9.02 D = 57.49
 PEAK HOUR LOCATION : VOLUME = 2063 DATE: 10/18/12 TIME: 04:45 PM