



8

Interval 60 min. 15 min.
 Binned(CL/SP) Count(volume)
Lane No 1 2

Direction Channel 1 _____
Direction Channel 2 _____
Unique ID# _____

Counter No. 454640 Count ID HPMS
SR 502 RRT/RRQ MP 7.50
7:05
Leg 1 Direction WB OSID _____

Station Description _ ON SR 502 W/O SR 503

Date	Day	Time	Comments			
10/31/11	2	1217	Manual (1) 2 (2)	SET OK	RT/CP	6.4
			Counter (1) 2 (2)			
11/1	3	1148	Manual (1) 50 (2)	CHECK OK	RT/CP	6.5
			Counter (1) 50 (2)			
11/2	4	0820	Manual (1) 30 (2)	CHECK OK	RT/CP	6.2
			Counter (1) 30 (2)			
11/3	5	1159	Manual (1) 5 (2)	CHECK OK	RT/CP	6.4
			Counter (1) 5 (2)			
11/4	6	0908	Manual (1) 1 (2)	P/U OK	RT/CP	6.2
			Counter (1) 1 (2)			

Sketch

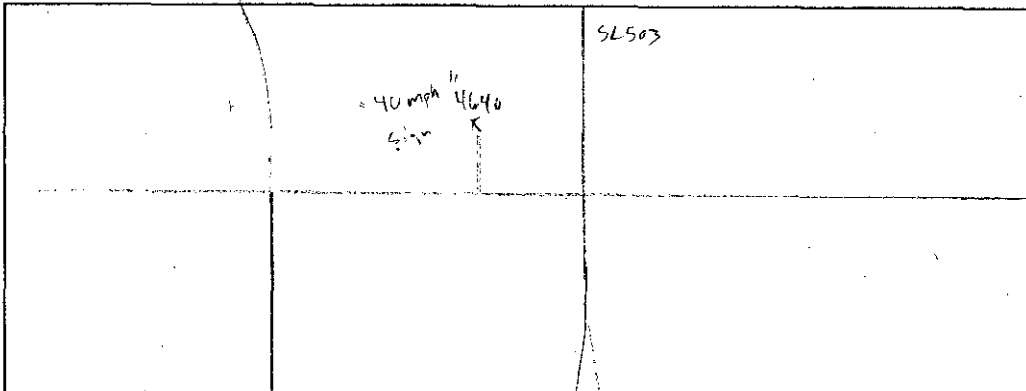

LT/CP
Field Person



Interval 60 min. 15 min.
 Binned(CL/SP) Count(volume)
Lane No 1 2

Direction Channel 1 _____
Direction Channel 2 _____
Unique ID# _____

Counter No. 455907 Count ID HPMS
SR 502 RRT/RRQ _____ MP 7.56
Leg 1 Direction EB OSID _____

Station Description ON SR 502 W/O SR 503

Date	Day	Time	Comments		
10/31/11	2	1211	Manual (1) <u>2</u> (2) _____ Counter (1) <u>2</u> (2) _____	SET OK	RT/CP 6.5
11/1	3	1142	Manual (1) <u>50</u> (2) _____ Counter (1) <u>50</u> (2) _____	CHECK OK	RT/CP 6.6
11/2	4	0815	Manual (1) <u>20</u> (2) _____ Counter (1) <u>19</u> (2) _____	CHECK OK 1=SP	RT/CP 6.4
11/3	5	1157	Manual (1) <u>5</u> (2) _____ Counter (1) <u>5</u> (2) _____	CHECK OK	RT/CP 6.6
11/4	6	0905	Manual (1) <u>1</u> (2) _____ Counter (1) <u>1</u> (2) _____	P/U OK	RT/CP 6.4

Sketch

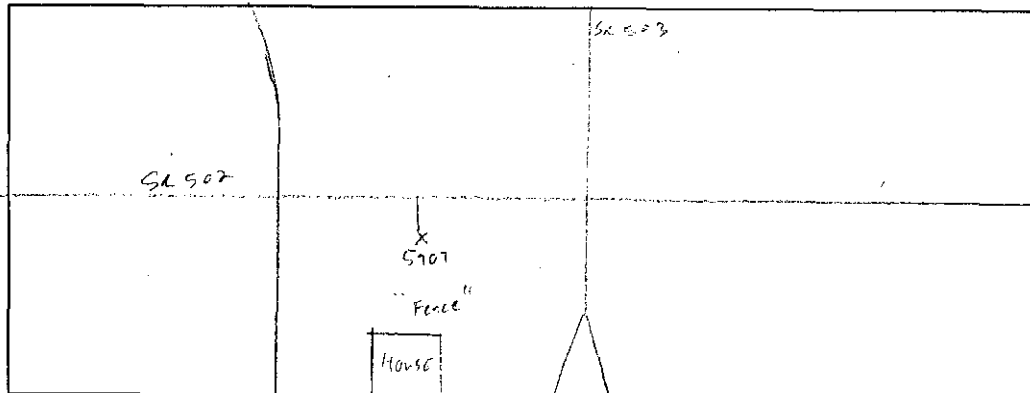

RT/CP

Field Person

SR 502 MP 007.56 OFF SYSTEM ID. LEG 1 DIRECTION OF TRAFFIC WESTBOUND LANE ALL OF

COUNT IDENTIFIER HPMS COUNTER NUMBER 454640 DESCRIPTION: ON SR 502 W/O SR 503

11/03/11 THURSDAY	AM HOURS												PM HOURS												DAILY TOTAL
	1	2	3	4	5	6	7	8	9	10	11	12	1	2	3	4	5	6	7	8	9	10	11	12	
12	1	2	3	4	5	6	7	8	9	10	11	12	1	2	3	4	5	6	7	8	9	10	11	12	61
TOT	27	38	46	115	323	526	623	751	859	823	1030	1046	1060	1080	975	1023	956	818	651	436	317	175	110	13869	
	AM PEAK HOUR 1100 TO 1200 VOLUME 1030												AM PEAK HOUR 0145 TO 0245 VOLUME 1113												AM TOTAL 5222
																									PM TOTAL 8647

11/04/11 FRIDAY	AM HOURS												PM HOURS												DAILY TOTAL
	1	2	3	4	5	6	7	8	9	10	11	12	1	2	3	4	5	6	7	8	9	10	11	12	
12	1	2	3	4	5	6	7	8	9	10	11	12	1	2	3	4	5	6	7	8	9	10	11	12	64
TOT	48	48	50	113	343	483	697	722																2568	
	AM PEAK HOUR 0730 TO 0830 VOLUME 755												AM PEAK HOUR 0000 TO 0000 VOLUME 0												AM TOTAL 2568
																									PM TOTAL 0

10/31/11 THRU 11/04/11 TOTAL HOURS FOR COUNT 92

3 DAYS AVG WEEKDAY VOL 13622 X SEASONAL ADJ. FACTOR 1.1100 = 15120 X AXLE CORR FACTOR 0.9805 = ESTIMATED AVG DAILY TRAFFIC 14825

FACTOR GROUP CB-02

FACTOR GROUP GR-B2

SR 502 MP 007.56 OFF SYSTEM ID. LEG 1 DIRECTION OF TRAFFIC EASTBOUND LANE ALL OF

COUNT IDENTIFIER HPMS COUNTER NUMBER 455907 DESCRIPTION: ON SR 502 W/O SR 503

10/31/11	AM HOURS												PM HOURS												DAILY TOTAL	
	1	2	3	4	5	6	7	8	9	10	11	12	1	2	3	4	5	6	7	8	9	10	11	12		
00-15	12	1	2	3	4	5	6	7	8	9	10	11	12	1	2	3	4	5	6	7	8	9	10	11	12	848
15-30	1	2	3	4	5	6	7	8	9	10	11	12	1	2	3	4	5	6	7	8	9	10	11	12	1064	
30-45																										1057
45-00																										1067
HOUR	AM PEAK HOUR 0000 TO 0000 VOLUME 1239												PM PEAK HOUR 0400 TO 0500 VOLUME 1239												AM TOTAL 0	
TOT																									PM TOTAL 0	

11/01/11	AM HOURS												PM HOURS												DAILY TOTAL	
	1	2	3	4	5	6	7	8	9	10	11	12	1	2	3	4	5	6	7	8	9	10	11	12		
00-15	12	1	2	3	4	5	6	7	8	9	10	11	12	1	2	3	4	5	6	7	8	9	10	11	12	893
15-30	1	2	3	4	5	6	7	8	9	10	11	12	1	2	3	4	5	6	7	8	9	10	11	12	1090	
30-45																										1131
45-00																										1187
HOUR	AM PEAK HOUR 1100 TO 1200 VOLUME 893												PM PEAK HOUR 0445 TO 0545 VOLUME 1235												AM TOTAL 4090	
TOT																									PM TOTAL 9314	

11/02/11	AM HOURS												PM HOURS												DAILY TOTAL	
	1	2	3	4	5	6	7	8	9	10	11	12	1	2	3	4	5	6	7	8	9	10	11	12		
00-15	12	1	2	3	4	5	6	7	8	9	10	11	12	1	2	3	4	5	6	7	8	9	10	11	12	828
15-30	1	2	3	4	5	6	7	8	9	10	11	12	1	2	3	4	5	6	7	8	9	10	11	12	1173	
30-45																										1108
45-00																										1132
HOUR	AM PEAK HOUR 1100 TO 1200 VOLUME 828												PM PEAK HOUR 0445 TO 0545 VOLUME 1173												AM TOTAL 3856	
TOT																									PM TOTAL 9124	

SR 502 MP 007.56 OFF SYSTEM ID. LEG 1 DIRECTION OF TRAFFIC EASTBOUND LANE ALL OF
COUNT IDENTIFIER HPMS COUNTER NUMBER 455907 DESCRIPTION: ON SR 502 W/O SR 503

11/03/11 THURSDAY	AM HOURS												PM HOURS												DAILY TOTAL
	1	2	3	4	5	6	7	8	9	10	11	12	1	2	3	4	5	6	7	8	9	10	11	12	
12	1	2	3	4	5	6	7	8	9	10	11	12	1	2	3	4	5	6	7	8	9	10	11	12	13290
TOT	67	44	20	30	44	124	243	546	538	686	726	884	1084	971	974	1094	1128	1159	1027	723	480	342	217	139	
									AM PEAK HOUR 1100 TO 1200 VOLUME 884												AM TOTAL 3952				
									PM PEAK HOUR 0430 TO 0530 VOLUME 1185													PM TOTAL 9338			

11/04/11 FRIDAY	AM HOURS												PM HOURS												DAILY TOTAL	
	1	2	3	4	5	6	7	8	9	10	11	12	1	2	3	4	5	6	7	8	9	10	11	12		
12	1	2	3	4	5	6	7	8	9	10	11	12	1	2	3	4	5	6	7	8	9	10	11	12	1772	
TOT	70	39	35	32	41	115	285	550	605																	
									AM PEAK HOUR 0730 TO 0830 VOLUME 664													AM TOTAL 1772				
									PM PEAK HOUR 0000 TO 0000 VOLUME 0														PM TOTAL 0			

10/31/11 THRU 11/04/11
TOTAL HOURS FOR COUNT 92

3 DAYS
AVG WEEKDAY VOL 13225 X SEASONAL ADJ. FACTOR 1.1100 = 14680 X AXLE CORR FACTOR 0.9805 = ESTIMATED AVG DAILY TRAFFIC 14394

FACTOR GROUP CB-02

FACTOR GROUP GR-B2

SR 502 MP 007.56 OFF SYSTEM ID. LEG 1 DIRECTION OF TRAFFIC BOTH WAYS LANE ALL OF
 COUNT IDENTIFIER HPMS COUNTER NUMBER 455907 DESCRIPTION: ON SR 502 W/O SR 503

COUNT IDENTIFIER	HPMS	COUNTER NUMBER	DESCRIPTION: ON SR 502 W/O SR 503												DAILY TOTAL												
			AM HOURS						PM HOURS																		
10/31/11 MONDAY			1	2	3	4	5	6	7	8	9	10	11	12	1	2	3	4	5	6	7	8	9	10	11	12	
00-15			12	1	2	3	4	5	6	7	8	9	10	11	552	536	560	540	522	514	331	306	249	136	86		
15-30			1	2	3	4	5	6	7	8	9	10	11	535	572	542	564	513	477	322	319	234	106	53			
30-45														523	519	509	529	569	508	436	323	282	191	102	45		
45-00														574	510	529	526	559	457	360	294	230	163	88	52		
TOT			1097	2116	2146	2157	2232	2000	1787	1270	1137	837	432	236	17447												17447

AM PEAK HOUR 0000 TO 0000 VOLUME 0
 PM PEAK HOUR 0400 TO 0500 VOLUME 2232

AM TOTAL 17447
 PM TOTAL 2232

COUNT IDENTIFIER	HPMS	COUNTER NUMBER	DESCRIPTION: ON SR 502 W/O SR 503												DAILY TOTAL													
			AM HOURS						PM HOURS																			
11/01/11 TUESDAY			1	2	3	4	5	6	7	8	9	10	11	12	1	2	3	4	5	6	7	8	9	10	11	12		
00-15			12	1	2	3	4	5	6	7	8	9	10	11	531	531	531	531	531	531	531	531	531	531	531	531	531	
15-30			1	2	3	4	5	6	7	8	9	10	11	484	484	484	484	484	484	484	484	484	484	484	484	484		
30-45														517	517	517	517	517	517	517	517	517	517	517	517	517		
45-00														502	502	502	502	502	502	502	502	502	502	502	502	502		
TOT			142	91	82	85	164	450	783	1193	1294	1507	1632	2030	1959	1993	2143	2117	2202	1834	1356	964	646	374	214	27110		

AM PEAK HOUR 1100 TO 1200 VOLUME 1855
 PM PEAK HOUR 0445 TO 0545 VOLUME 2282

AM TOTAL 9278
 PM TOTAL 17832

COUNT IDENTIFIER	HPMS	COUNTER NUMBER	DESCRIPTION: ON SR 502 W/O SR 503												DAILY TOTAL													
			AM HOURS						PM HOURS																			
11/02/11 WEDNESDAY			1	2	3	4	5	6	7	8	9	10	11	12	1	2	3	4	5	6	7	8	9	10	11	12		
00-15			12	1	2	3	4	5	6	7	8	9	10	11	481	481	481	481	481	481	481	481	481	481	481	481	481	
15-30			1	2	3	4	5	6	7	8	9	10	11	458	458	458	458	458	458	458	458	458	458	458	458	458		
30-45														521	521	521	521	521	521	521	521	521	521	521	521	521		
45-00														525	525	525	525	525	525	525	525	525	525	525	525	525		
TOT			128	89	75	69	161	417	695	1050	1363	1493	1474	1764	1951	1870	1984	2084	2093	2202	1846	1265	948	683	356	210	26270	

AM PEAK HOUR 1100 TO 1200 VOLUME 1764
 PM PEAK HOUR 0445 TO 0545 VOLUME 2233

AM TOTAL 8778
 PM TOTAL 17492

