

Ru

Interval  60 min.  15 min.  
 Binned(CL/SP)  Count(volume)  
Lane No  1  2

Direction Channel 1 \_\_\_\_\_  
Direction Channel 2 \_\_\_\_\_  
Unique ID# \_\_\_\_\_

Counter No. 281698 Count ID 19-001  
SR 5 RRT/RRQ S1 00387 MP 0.04  
Leg 2 Direction SB OSID \_\_\_\_\_

Station Description ON SR 5 SB ON RAMP FROM NW 78TH ST

Date	Day	Time	Comments
7/8/19	2	12:21	Manual (1) <u>3</u> (2) _____ SET COUNTER SS/JH 6.4v Counter (1) <u>3</u> (2) _____
7/9/19	3	14:41	Manual (1) <u>34</u> (2) _____ CHECK COUNTER SS/JH 6.8v Counter (1) <u>34</u> (2) _____
7/10/19	4	12:02	Manual (1) <u>50</u> (2) _____ CHECK COUNTER SS/JH 7.0v Counter (1) <u>50</u> (2) _____
7/11/19	5	11:18	Manual (1) <u>27</u> (2) _____ CHECK COUNTER SS/JH 7.0v Counter (1) <u>27</u> (2) _____
7/12/19	6	<u>8:41</u>	Manual (1) <u>/</u> (2) _____ P/U COUNTER SS/JH <u>7.0v</u> Counter (1) <u>/</u> (2) _____

Sketch

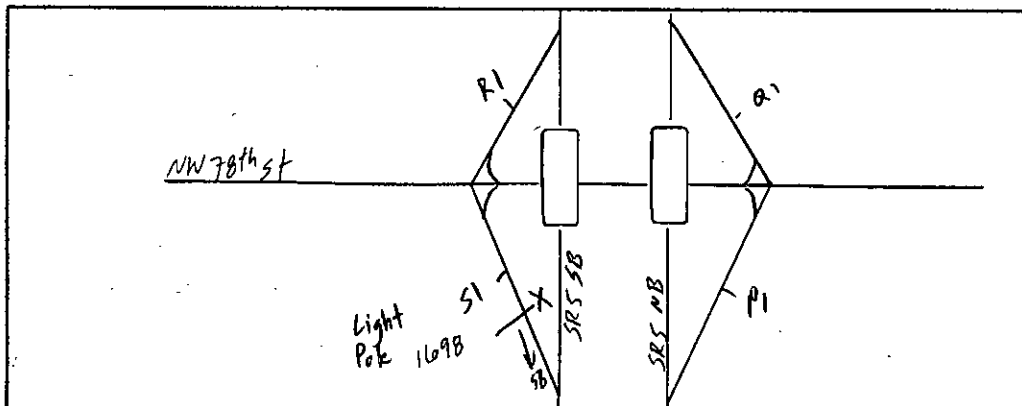

Field Person

STATE OF WASHINGTON - DEPARTMENT OF TRANSPORTATION  
T R I P S S Y S T E M  
15 MINUTE TRAFFIC COUNT SUMMARY

SR 005 S100387 MP 000.04		OFF SYSTEM ID.		LEG 2		DIRECTION OF TRAFFIC SOUTHBOUND										LANE ALL OF										
COUNT IDENTIFIER	19-001	COUNTER NUMBER	281698	DESCRIPTION: ON SR 5 SB ON RAMP FROM NW 78TH ST																						
07/08/19 MONDAY				AM HOURS						PM HOURS																
	12	1	2	3	4	5	6	7	8	9	10	11	12	1	2	3	4	5	6	7	8	9	10	11	DAILY	
	1	2	3	4	5	6	7	8	9	10	11	12	1	2	3	4	5	6	7	8	9	10	11	12	TOTAL	
00-15														202	180	163	169	212	188	160	115	96	78	35		
15-30														218	212	132	161	197	169	140	105	79	66	30		
30-45													222	194	161	187	190	204	158	132	114	82	37	19		
45-00													219	184	186	174	169	198	123	112	102	51	28	27		
HOUR	-----																									
TOT														441	798	739	656	689	811	638	544	436	308	209	111	6380

AM PEAK HOUR 0000 TO 0000 VOLUME 0 AM TOTAL 0  
PM PEAK HOUR 1230 TO 0130 VOLUME 861 PM TOTAL 6380

07/09/19 TUESDAY				AM HOURS						PM HOURS																
	12	1	2	3	4	5	6	7	8	9	10	11	12	1	2	3	4	5	6	7	8	9	10	11	DAILY	
	1	2	3	4	5	6	7	8	9	10	11	12	1	2	3	4	5	6	7	8	9	10	11	12	TOTAL	
00-15	15	22	16	20	34	97	165	107	141	177	183	230	219	210	194	166	179	236	167	133	107	103	56	28		
15-30	12	14	19	24	49	127	134	149	171	197	190	201	224	218	190	191	185	223	186	131	88	84	40	35		
30-45	17	19	10	29	51	181	132	154	194	197	196	226	229	194	208	190	212	212	179	128	105	70	46	30		
45-00	15	14	15	25	64	126	115	132	190	191	207	208	248	183	176	173	189	187	172	113	91	64	38	22		
HOUR	-----																									
TOT	59	69	60	98	198	531	546	542	696	762	776	865	920	805	768	720	765	858	704	505	391	321	180	115	12254	

AM PEAK HOUR 1100 TO 1200 VOLUME 865 AM TOTAL 5202  
PM PEAK HOUR 1200 TO 0100 VOLUME 920 PM TOTAL 7052

07/10/19 WEDNESDAY				AM HOURS						PM HOURS																
	12	1	2	3	4	5	6	7	8	9	10	11	12	1	2	3	4	5	6	7	8	9	10	11	DAILY	
	1	2	3	4	5	6	7	8	9	10	11	12	1	2	3	4	5	6	7	8	9	10	11	12	TOTAL	
00-15	17	16	16	14	33	96	154	134	154	213	196	207	218	213	192	181	193	218	212	146	103	95	57	42		
15-30	12	6	27	26	44	138	135	146	153	184	183	202	198	226	210	164	174	209	191	157	112	78	61	31		
30-45	12	15	20	29	52	151	137	152	181	184	214	251	203	216	172	197	174	193	187	146	89	70	47	25		
45-00	17	8	16	21	57	131	135	138	190	182	179	219	230	192	194	184	178	201	176	131	98	61	30	13		
HOUR	-----																									
TOT	58	45	79	90	186	516	561	570	678	763	772	879	849	847	768	726	719	821	766	580	402	304	195	111	12285	

AM PEAK HOUR 1100 TO 1200 VOLUME 879 AM TOTAL 5197  
PM PEAK HOUR 1245 TO 0145 VOLUME 885 PM TOTAL 7088

STATE OF WASHINGTON - DEPARTMENT OF TRANSPORTATION  
 TRIP SYSTEM  
 15 MINUTE TRAFFIC COUNT SUMMARY

SR 005 S100387 MP 000.04 OFF SYSTEM ID. LEG 2 DIRECTION OF TRAFFIC SOUTHBOUND LANE ALL OF

COUNT IDENTIFIER 19-001 COUNTER NUMBER 281698 DESCRIPTION: ON SR 5 SB ON RAMP FROM NW 78TH ST

07/11/19 THURSDAY												PM HOURS												DAILY TOTAL	
AM HOURS																									
12	1	2	3	4	5	6	7	8	9	10	11	12	1	2	3	4	5	6	7	8	9	10	11	12	
17	19	8	12	36	98	145	128	147	189	176	183	213	229	213	175	205	232	179	157	115	86	87	53		
15-30	16	13	13	27	41	141	127	140	168	200	193	230	222	219	187	167	183	205	185	159	107	109	71	46	
30-45	22	18	11	25	58	162	136	143	187	181	200	223	222	214	186	175	207	196	185	122	122	95	50	45	
45-00	14	19	14	38	56	119	136	154	199	207	226	256	218	204	204	175	175	193	166	110	88	68	59	30	
HOUR	-----												-----												
TOT	69	69	46	102	191	520	544	565	701	777	795	892	875	866	790	692	770	826	715	548	432	358	267	174	12584

AM PEAK HOUR 1100 TO 1200 VOLUME 892 AM TOTAL 5271  
 PM PEAK HOUR 1215 TO 0115 VOLUME 891 PM TOTAL 7313

07/12/19 FRIDAY												PM HOURS												DAILY TOTAL	
AM HOURS																									
12	1	2	3	4	5	6	7	8	9	10	11	12	1	2	3	4	5	6	7	8	9	10	11	12	
31	17	12	11	23	76	157	171	196																	
15-30	23	16	22	22	50	106	133	170	155																
30-45	27	23	11	25	51	150	175	196																	
45-00	17	12	10	39	60	129	154	175																	
HOUR	-----												-----												
TOT	98	68	55	97	184	461	619	712	351																2645

AM PEAK HOUR 0715 TO 0815 VOLUME 737 AM TOTAL 2645  
 PM PEAK HOUR 0000 TO 0000 VOLUME 0 PM TOTAL 0

07/08/19 THRU 07/12/19  
 TOTAL HOURS FOR COUNT 91

3 DAYS FACTOR GROUP P5S FACTOR GROUP P5S  
 AVG WEEKDAY VOL 12374 X SEASONAL ADJ. FACTOR 0.9500 = 11755 X AXLE CORR FACTOR 0.9092 = ESTIMATED AVG DAILY TRAFFIC 10688

PEAK HOUR PERCENTAGES: K = 7.45 D = 100.00  
 PEAK HOUR LOCATION : VOLUME = 922 DATE: 07/11/19 TIME: 11:15 AM

*ru*

Interval  60 min.  15 min.  
 Binned(CL/SP)  Count(volume)  
Lane No  1  2

---

Direction Channel 1 \_\_\_\_\_  
Direction Channel 2 \_\_\_\_\_  
Unique ID# \_\_\_\_\_

Counter No. 285896 Count ID 19-001  
SR 5 RRT/RRQ R1 00479 MP 0.00  
Leg 2 Direction SB OSID \_\_\_\_\_

Station Description ON SR 5 SB OFF RAMP TO NW 78TH ST

Date	Day	Time	Comments
7/8/19	2	12:11	Manual (1) <u>2</u> (2) _____ SET COUNTER SS/JH 6.3v Counter (1) <u>2</u> (2) _____
7/9/19	3	14:31	Manual (1) <u>37</u> (2) _____ CHECK COUNTER SS/JH 6.4v Counter (1) <u>37</u> (2) _____
7/10/19	4	11:50	Manual (1) <u>50</u> (2) _____ CHECK COUNTER SS/JH 6.3v Counter (1) <u>50</u> (2) _____
7/11/19	5	11:02	Manual (1) <u>21</u> (2) _____ CHECK COUNTER SS/JH 6.3v Counter (1) <u>21</u> (2) _____
7/12/19	6	<u>8:35</u>	Manual (1) <u>1</u> (2) _____ P/U COUNTER SS/JH <u>6.2</u> Counter (1) <u>1</u> (2) _____

Sketch

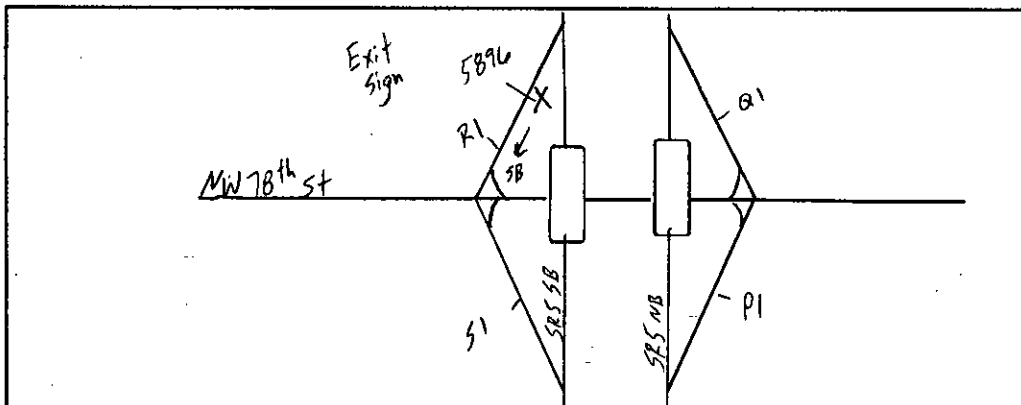

Field Person *67*

STATE OF WASHINGTON - DEPARTMENT OF TRANSPORTATION  
T R I P S S Y S T E M  
15 MINUTE TRAFFIC COUNT SUMMARY

SR 005 R100479 MP 000.00		OFF SYSTEM ID.		LEG 2		DIRECTION OF TRAFFIC SOUTHBOUND										LANE ALL OF											
COUNT IDENTIFIER 19-001		COUNTER NUMBER 285896		DESCRIPTION: ON SR 5 SB OFF RAMP TO NW 78TH ST																							
07/08/19 MONDAY		AM HOURS										PM HOURS										DAILY					
		12	1	2	3	4	5	6	7	8	9	10	11	12	1	2	3	4	5	6	7	8	9	10	11	TOTAL	
00-15															151	115	146	140	162	112	75	61	42	31	18		
15-30														134	149	137	151	177	144	111	67	55	37	27	13		
30-45														152	132	139	139	170	138	111	62	46	32	21	13		
45-00														135	135	140	144	125	120	119	69	50	37	17	16		
HOUR														-----													
TOT														421	567	531	580	612	564	453	273	212	148	96	60	4517	

AM PEAK HOUR 0000 TO 0000 VOLUME 0 AM TOTAL 0  
PM PEAK HOUR 0415 TO 0515 VOLUME 634 PM TOTAL 4517

07/09/19 TUESDAY		AM HOURS										PM HOURS										DAILY				
		12	1	2	3	4	5	6	7	8	9	10	11	12	1	2	3	4	5	6	7	8	9	10	11	TOTAL
00-15		4	8	7	6	9	26	85	101	136	122	113	116	131	130	121	135	136	148	97	86	62	47	31	13	
15-30		11	8	10	15	23	35	102	144	127	126	105	137	139	127	126	145	174	153	116	72	58	27	26	8	
30-45		9	4	9	8	17	72	109	157	107	125	136	163	150	152	136	130	145	144	82	70	50	28	21	10	
45-00		15	9	9	13	39	93	144	162	143	120	138	157	159	138	116	169	164	133	100	65	66	26	29	12	
HOUR																										
TOT		39	29	35	42	88	226	440	564	513	493	492	573	579	547	499	579	619	578	395	293	236	128	107	43	8137

AM PEAK HOUR 0715 TO 0815 VOLUME 599 AM TOTAL 3534  
PM PEAK HOUR 0415 TO 0515 VOLUME 631 PM TOTAL 4603

07/10/19 WEDNESDAY		AM HOURS										PM HOURS										DAILY				
		12	1	2	3	4	5	6	7	8	9	10	11	12	1	2	3	4	5	6	7	8	9	10	11	TOTAL
00-15		6	3	3	4	15	26	61	114	130	116	131	128	135	150	127	126	123	141	122	88	66	38	32	8	
15-30		2	5	8	7	18	41	95	137	108	145	109	149	148	112	150	149	158	166	124	83	53	40	23	15	
30-45		7	6	3	10	21	75	119	111	146	129	118	127	171	133	105	121	144	137	109	81	47	33	21	13	
45-00		11	7	14	14	35	82	145	149	140	134	164	158	152	126	132	135	157	160	96	69	59	39	24	13	
HOUR																										
TOT		26	21	28	35	89	224	420	511	524	524	522	562	606	521	514	531	582	604	451	321	225	150	100	49	8140

AM PEAK HOUR 1045 TO 1145 VOLUME 568 AM TOTAL 3486  
PM PEAK HOUR 1215 TO 0115 VOLUME 621 PM TOTAL 4654

STATE OF WASHINGTON - DEPARTMENT OF TRANSPORTATION  
T R I P S S Y S T E M  
15 MINUTE TRAFFIC COUNT SUMMARY

SR 005 R100479 MP 000.00 OFF SYSTEM ID. LEG 2 DIRECTION OF TRAFFIC SOUTHBOUND LANE ALL OF  
COUNT IDENTIFIER 19-001 COUNTER NUMBER 285896 DESCRIPTION: ON SR 5 SB OFF RAMP TO NW 78TH ST

07/11/19 THURSDAY												PM HOURS												DAILY TOTAL	
AM HOURS																									
12	1	2	3	4	5	6	7	8	9	10	11	12	1	2	3	4	5	6	7	8	9	10	11		
1	2	3	4	5	6	7	8	9	10	11	12	1	2	3	4	5	6	7	8	9	10	11	12		
00-15	8	3	6	8	19	33	84	120	142	120	147	160	136	165	122	104	153	150	120	81	67	42	46	21	
15-30	7	9	7	8	20	29	81	129	131	118	109	154	179	160	139	122	160	182	140	88	51	54	28	38	
30-45	11	6	11	7	13	76	129	149	127	131	119	160	153	144	115	125	148	149	103	83	77	42	33	26	
45-00	9	10	7	9	40	92	142	174	154	157	143	185	150	127	132	175	146	133	123	57	45	43	28	16	
HOUR	-----																								
TOT	35	28	31	32	92	230	436	572	554	526	518	659	618	596	508	526	607	614	486	309	240	181	135	101	8634

AM PEAK HOUR 1100 TO 1200 VOLUME 659 AM TOTAL 3713  
PM PEAK HOUR 1215 TO 0115 VOLUME 647 PM TOTAL 4921

07/12/19 FRIDAY												PM HOURS												DAILY TOTAL	
AM HOURS																									
12	1	2	3	4	5	6	7	8	9	10	11	12	1	2	3	4	5	6	7	8	9	10	11		
1	2	3	4	5	6	7	8	9	10	11	12	1	2	3	4	5	6	7	8	9	10	11	12		
00-15	15	4	6	11	14	20	77	87	114																
15-30	19	7	9	3	21	31	82	131	129																
30-45	13	10	10	9	25	77	104	134																	
45-00	11	12	14	4	28	76	122	170																	
HOUR	-----																								
TOT	58	33	39	27	88	204	385	522	243																1599

AM PEAK HOUR 0715 TO 0815 VOLUME 549 AM TOTAL 1599  
PM PEAK HOUR 0000 TO 0000 VOLUME 0 PM TOTAL 0

07/08/19 THRU 07/12/19  
TOTAL HOURS FOR COUNT 91

3 DAYS FACTOR GROUP P5S FACTOR GROUP P5S  
AVG WEEKDAY VOL 8304 X SEASONAL ADJ. FACTOR 0.9500 = 7889 X AXLE CORR FACTOR 0.9092 = ESTIMATED AVG DAILY TRAFFIC 7173

PEAK HOUR PERCENTAGES: K = 7.95 D = 100.00  
PEAK HOUR LOCATION : VOLUME = 660 DATE: 07/11/19 TIME: 11:30 AM

RU

Interval  60 min.  15 min.  
 Binned(CL/SP)  Count(volume)  
Lane No  1  2

---

Direction Channel 1 \_\_\_\_\_  
Direction Channel 2 \_\_\_\_\_  
Unique ID# \_\_\_\_\_

Counter No. 281696 Count ID 19-001  
SR 5 RRT/RRQ Q1 00472 MP 0.04  
Leg 2 Direction NB OSID \_\_\_\_\_

Station Description ON SR 5 NB ON RAMP FROM NE 78TH ST

Date	Day	Time	Comments
7/8/19	2	12:51	Manual (1) <u>2</u> (2) _____ SET COUNTER SS/JH 6.4v Counter (1) <u>2</u> (2) _____
7/9/19	3	7:43	Manual (1) <u>23</u> (2) _____ CHECK COUNTER SS/JH 6.5v Counter (1) <u>23</u> (2) _____
7/10/19	4	8:46	Manual (1) <u>26</u> (2) _____ CHECK COUNTER SS/JH 6.6v Counter (1) <u>26</u> (2) _____
7/11/19	5	8:17	Manual (1) <u>26</u> (2) _____ CHECK COUNTER SS/JH 6.6v Counter (1) <u>26</u> (2) _____
7/12/19	6	6:47	Manual (1) <u>1</u> (2) _____ P/U COUNTER SS/JH 6.4v Counter (1) <u>1</u> (2) _____

Sketch

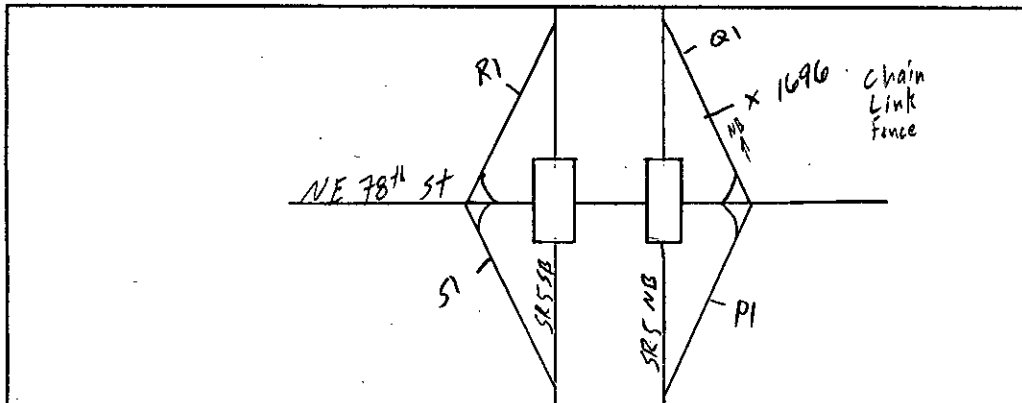

Field Person

STATE OF WASHINGTON - DEPARTMENT OF TRANSPORTATION  
TRIP SYSTEM  
15 MINUTE TRAFFIC COUNT SUMMARY

SR 005 Q100472 MP 000.04 OFF SYSTEM ID. LEG 2 DIRECTION OF TRAFFIC NORTHBOUND LANE ALL OF

COUNT IDENTIFIER 19-001 COUNTER NUMBER 281696 DESCRIPTION: ON SR 5 NB ON RAMP FROM NE 78TH ST

07/08/19 MONDAY													PM HOURS											DAILY TOTAL
AM HOURS																								
12	1	2	3	4	5	6	7	8	9	10	11	12	1	2	3	4	5	6	7	8	9	10	11	
1	2	3	4	5	6	7	8	9	10	11	12	1	2	3	4	5	6	7	8	9	10	11		
													122	144	153	189	196	143	101	88	72	31	30	
													155	143	146	175	195	129	97	75	49	30	17	
													125	127	188	213	162	139	77	75	45	28	19	
													134	120	160	162	154	112	71	76	43	39	10	
HOUR																								
TOT													536	534	647	739	707	523	346	314	209	128	76	4759

AM PEAK HOUR 0000 TO 0000 VOLUME 0 AM TOTAL 0  
PM PEAK HOUR 0430 TO 0530 VOLUME 766 PM TOTAL 4759

07/09/19 TUESDAY													PM HOURS											DAILY TOTAL														
AM HOURS																																						
12	1	2	3	4	5	6	7	8	9	10	11	12	1	2	3	4	5	6	7	8	9	10	11															
1	2	3	4	5	6	7	8	9	10	11	12	1	2	3	4	5	6	7	8	9	10	11																
													13	15	15	16	7	22	32	54	90	92	83	133	122	150	135	127	178	195	157	115	105	71	31	32		
													15	30	12	5	12	8	12	35	36	77	82	97	98	105	138	134	152	136	145	182	129	103	73	55	43	20
													12	4	7	4	17	33	71	98	89	107	93	126	153	160	150	173	197	183	124	84	69	67	29	19		
													15	11	9	10	13	39	77	107	84	105	115	130	127	144	124	171	176	150	122	88	80	37	33	9		
HOUR																																						
TOT													52	35	43	38	49	129	216	336	345	401	389	494	540	588	561	607	696	710	532	390	327	230	136	80	7924	

AM PEAK HOUR 1100 TO 1200 VOLUME 494 AM TOTAL 2527  
PM PEAK HOUR 0430 TO 0530 VOLUME 750 PM TOTAL 5397

07/10/19 WEDNESDAY													PM HOURS											DAILY TOTAL													
AM HOURS																																					
12	1	2	3	4	5	6	7	8	9	10	11	12	1	2	3	4	5	6	7	8	9	10	11														
1	2	3	4	5	6	7	8	9	10	11	12	1	2	3	4	5	6	7	8	9	10	11															
													3	15	16	17	7	21	37	61	85	111	109	122	132	150	139	167	212	183	166	106	112	73	36	34	
													11	8	8	5	14	25	42	70	96	82	121	119	139	149	141	157	193	192	149	108	76	59	29	22	
													10	5	6	7	14	36	60	78	75	108	105	110	126	108	146	160	182	172	126	89	90	68	37	9	
													16	4	11	10	15	40	78	99	110	86	116	106	114	154	139	199	180	161	113	80	75	40	30	14	
HOUR																																					
TOT													40	32	41	39	50	122	217	308	366	387	451	457	511	561	565	683	767	708	554	383	353	240	132	79	8046

AM PEAK HOUR 1045 TO 1145 VOLUME 467 AM TOTAL 2510  
PM PEAK HOUR 0345 TO 0445 VOLUME 786 PM TOTAL 5536



STATE OF WASHINGTON - DEPARTMENT OF TRANSPORTATION  
 TRIP SYSTEM  
 15 MINUTE TRAFFIC COUNT SUMMARY

SR 005 Q100472 MP 000.04 OFF SYSTEM ID. LEG 2 DIRECTION OF TRAFFIC NORTHBOUND LANE ALL OF  
 COUNT IDENTIFIER 19-001 COUNTER NUMBER 281696 DESCRIPTION: ON SR 5 NB ON RAMP FROM NE 78TH ST

07/11/19 THURSDAY												PM HOURS												DAILY TOTAL
AM HOURS																								
12	1	2	3	4	5	6	7	8	9	10	11	12	1	2	3	4	5	6	7	8	9	10	11	12
9	12	7	9	12	22	37	55	101	96	107	115	133	147	144	176	163	198	140	116	104	97	44	31	
14	7	6	10	27	19	38	97	87	110	116	107	140	137	155	120	172	190	146	123	87	79	35	34	
11	13	13	10	8	34	80	84	88	101	105	135	147	151	163	166	196	164	116	99	72	62	28	21	
24	13	8	13	23	38	82	100	111	107	128	137	132	139	135	167	165	177	115	102	71	52	54	17	
TOT	58	45	34	42	70	113	237	336	387	414	456	494	552	574	597	629	696	729	517	440	334	290	161	103

AM PEAK HOUR 1100 TO 1200 VOLUME 494 AM TOTAL 2686  
 PM PEAK HOUR 0430 TO 0530 VOLUME 749 PM TOTAL 5622

07/12/19 FRIDAY												PM HOURS												DAILY TOTAL
AM HOURS																								
12	1	2	3	4	5	6	7	8	9	10	11	12	1	2	3	4	5	6	7	8	9	10	11	12
21	12	10	10	13	27	36																		
18	12	13	8	11	27	51																		
30	7	5	14	8	36	49																		
14	5	6	2	24	36																			
TOT	83	36	34	34	56	126	136																	

AM PEAK HOUR 0545 TO 0645 VOLUME 172 AM TOTAL 505  
 PM PEAK HOUR 0000 TO 0000 VOLUME 0 PM TOTAL 0

07/08/19 THRU 07/12/19  
 TOTAL HOURS FOR COUNT 89

3 DAYS FACTOR GROUP P5S FACTOR GROUP P5S  
 AVG WEEKDAY VOL 8093 X SEASONAL ADJ. FACTOR 0.9500 = 7688 X AXLE CORR FACTOR 0.9092 = ESTIMATED AVG DAILY TRAFFIC 6990

PEAK HOUR PERCENTAGES: K = 9.71 D = 100.00  
 PEAK HOUR LOCATION : VOLUME = 786 DATE: 07/10/19 TIME: 03:45 PM

*RU*

Interval  60 min.  15 min.  
 Binned(CL/SP)  Count(volume)  
Lane No  1  2

Direction Channel 1 \_\_\_\_\_  
Direction Channel 2 \_\_\_\_\_  
Unique ID# \_\_\_\_\_

Counter No. 284649 Count ID 19-001  
SR 5 RRT/RRQ P1 00391 MP 0.00  
Leg 2 Direction NB OSID \_\_\_\_\_

Station Description ON SR 5 NB OFF RAMP TO NE 78TH ST

Date	Day	Time	Comments
7/8/19	2	12:41	Manual (1) <u>2</u> (2) _____ SET COUNTER SS/JH 6.4v Counter (1) <u>2</u> (2) _____
7/9/19	3	7:35	Manual (1) <u>20</u> (2) _____ CHECK COUNTER SS/JH 6.6v Counter (1) <u>20</u> (2) _____
7/10/19	4	8:26	Manual (1) <u>50</u> (2) _____ CHECK COUNTER SS/JH 6.6v 1-SP Counter (1) <u>49</u> (2) _____
7/11/19	5	8:05	Manual (1) <u>31</u> (2) _____ CHECK COUNTER SS/JH 6.6v Counter (1) <u>31</u> (2) _____
7/12/19	6	<u>6:41</u>	Manual (1) <u>1</u> (2) _____ P/U COUNTER SS/JH <u>6.4v</u> Counter (1) <u>1</u> (2) _____

Sketch

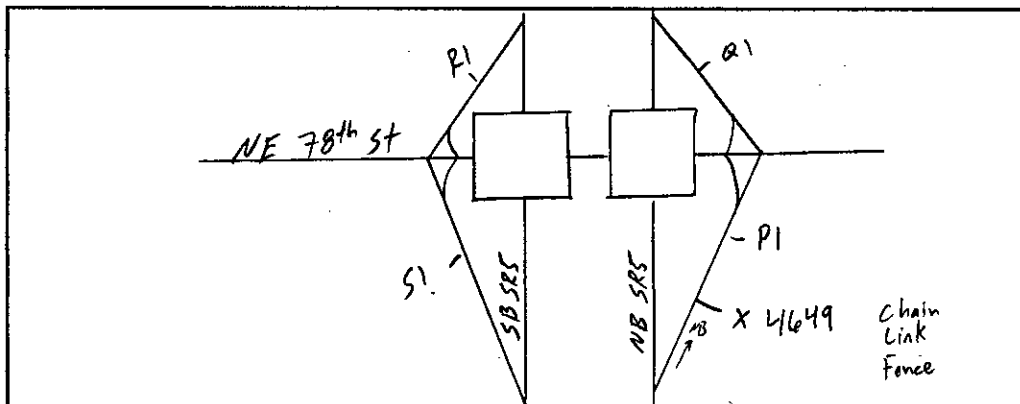

*GS*  
Field Person

STATE OF WASHINGTON - DEPARTMENT OF TRANSPORTATION  
T R I P S S Y S T E M  
15 MINUTE TRAFFIC COUNT SUMMARY

SR 005 P100391 MP 000.00		OFF SYSTEM ID.		LEG 2		DIRECTION OF TRAFFIC NORTHBOUND															LANE ALL OF							
COUNT IDENTIFIER 19-001		COUNTER NUMBER 284649		DESCRIPTION: ON SR 5 NB OFF RAMP TO NE 78TH ST																								
07/08/19 MONDAY		AM HOURS										PM HOURS										DAILY TOTAL						
	12	1	2	3	4	5	6	7	8	9	10	11	12	1	2	3	4	5	6	7	8	9	10	11	12			
00-15														263	226	233	336	366	283	251	168	136	77	56				
15-30														249	265	277	325	340	270	206	148	109	84	52				
30-45														221	240	277	301	326	270	177	142	122	74	32				
45-00														231	232	303	290	327	259	247	146	130	114	75	33			
HOUR	-----																											
TOT														231	965	1034	1077	1289	1291	1070	780	588	481	310	173	9289		

AM PEAK HOUR 0000 TO 0000 VOLUME 0 AM TOTAL 0  
PM PEAK HOUR 0445 TO 0545 VOLUME 1359 PM TOTAL 9289

07/09/19 TUESDAY		AM HOURS										PM HOURS										DAILY TOTAL					
	12	1	2	3	4	5	6	7	8	9	10	11	12	1	2	3	4	5	6	7	8	9	10	11	12		
00-15	27	21	16	12	10	23	52	68	92	137	145	218	253	219	243	291	277	316	280	227	167	118	78	48			
15-30	27	17	16	13	18	26	52	105	156	151	195	211	239	285	295	304	311	337	277	229	217	134	81	61			
30-45	25	21	18	17	18	50	73	104	139	181	173	230	247	247	232	292	325	344	269	203	172	108	79	35			
45-00	17	21	13	16	33	56	92	146	170	205	231	289	283	259	270	323	305	287	257	186	149	87	58	29			
HOUR	-----																										
TOT	96	80	63	58	79	155	269	423	557	674	744	948	1022	1010	1040	1210	1218	1284	1083	845	705	447	296	173	14479		

AM PEAK HOUR 1100 TO 1200 VOLUME 948 AM TOTAL 4146  
PM PEAK HOUR 0445 TO 0545 VOLUME 1302 PM TOTAL 10333

07/10/19 WEDNESDAY		AM HOURS										PM HOURS										DAILY TOTAL					
	12	1	2	3	4	5	6	7	8	9	10	11	12	1	2	3	4	5	6	7	8	9	10	11	12		
00-15	30	16	16	9	22	32	54	77	111	122	151	218	292	278	255	267	331	339	289	254	163	113	91	51			
15-30	26	15	7	6	20	29	59	100	147	141	172	214	240	253	243	304	327	354	253	245	150	134	90	51			
30-45	30	17	16	15	22	46	79	110	144	159	165	244	254	270	283	306	336	336	250	212	151	115	74	45			
45-00	22	13	11	14	31	51	75	126	157	188	206	285	274	289	258	320	334	279	267	220	155	115	69	40			
HOUR	-----																										
TOT	108	61	50	44	95	158	267	413	559	610	694	961	1060	1090	1039	1197	1328	1308	1059	931	619	477	324	187	14639		

AM PEAK HOUR 1100 TO 1200 VOLUME 961 AM TOTAL 4020  
PM PEAK HOUR 0445 TO 0545 VOLUME 1363 PM TOTAL 10619

STATE OF WASHINGTON - DEPARTMENT OF TRANSPORTATION  
T R I P S S Y S T E M  
15 MINUTE TRAFFIC COUNT SUMMARY

SR 005 P100391 MP 000.00 OFF SYSTEM ID. LEG 2 DIRECTION OF TRAFFIC NORTHBOUND LANE ALL OF

COUNT IDENTIFIER 19-001 COUNTER NUMBER 284649 DESCRIPTION: ON SR 5 NB OFF RAMP TO NE 78TH ST

07/11/19 THURSDAY												07/11/19 THURSDAY												DAILY TOTAL	
AM HOURS						PM HOURS						PM HOURS													
12	1	2	3	4	5	6	7	8	9	10	11	12	1	2	3	4	5	6	7	8	9	10	11		
1	2	3	4	5	6	7	8	9	10	11	12	1	2	3	4	5	6	7	8	9	10	11	12		
00-15	25	21	15	20	14	24	44	86	124	137	174	201	268	244	237	283	305	312	269	226	197	179	117	79	
15-30	40	21	13	15	20	31	80	87	122	150	195	232	268	251	290	271	304	321	295	252	200	154	96	56	
30-45	36	10	14	9	13	42	89	109	140	113	195	234	237	260	276	291	355	295	262	238	187	142	83	51	
45-00	21	12	11	17	21	49	73	147	148	163	228	270	255	250	255	298	326	290	220	229	196	101	75	49	
HOUR	-----																								
TOT	122	64	53	61	68	146	286	429	534	563	792	937	1028	1005	1058	1143	1290	1218	1046	945	780	576	371	235	14750

AM PEAK HOUR 1100 TO 1200 VOLUME 937 AM TOTAL 4055  
PM PEAK HOUR 0430 TO 0530 VOLUME 1314 PM TOTAL 10695

07/12/19 FRIDAY												07/12/19 FRIDAY												DAILY TOTAL	
AM HOURS						PM HOURS						PM HOURS													
12	1	2	3	4	5	6	7	8	9	10	11	12	1	2	3	4	5	6	7	8	9	10	11		
1	2	3	4	5	6	7	8	9	10	11	12	1	2	3	4	5	6	7	8	9	10	11	12		
00-15	49	28	24	17	16	23	40																		
15-30	39	24	21	9	14	27	69																		
30-45	29	20	11	6	14	52																			
45-00	27	8	19	18	27	63																			
HOUR	-----																								
TOT	144	80	75	50	71	165	109																		694

AM PEAK HOUR 0530 TO 0630 VOLUME 224 AM TOTAL 694  
PM PEAK HOUR 0000 TO 0000 VOLUME 0 PM TOTAL 0

07/08/19 THRU 07/12/19  
TOTAL HOURS FOR COUNT 89

3 DAYS FACTOR GROUP P5S FACTOR GROUP P5S  
AVG WEEKDAY VOL 14623 X SEASONAL ADJ. FACTOR 0.9500 = 13892 X AXLE CORR FACTOR 0.9092 = ESTIMATED AVG DAILY TRAFFIC 12631

PEAK HOUR PERCENTAGES: K = 9.32 D = 100.00  
PEAK HOUR LOCATION : VOLUME = 1363 DATE: 07/10/19 TIME: 04:30 PM