



*RU*

Interval  60 min.  15 min.  
 Binned(CL/SP)  Count(volume)  
 Lane No  1  2

Direction Channel 1 \_\_\_\_\_  
 Direction Channel 2 \_\_\_\_\_  
 Unique ID# \_\_\_\_\_

Counter No. 174908 Count ID HPMS  
 SR 14 RRT/RRQ MP 16.12  
 Leg 2 Direction WB OSID \_\_\_\_\_

Station Description ON SR-14 E/O Washougal River rd wye conn

DEL. EB FROM CLASS. - RU

Date	Day	Time	Comments
4/20/15	2	11:34	Manual (1) <u>4</u> (2) _____ Set up ok JDM/BJ 6.5v Counter (1) <u>4</u> (2) _____
4/21/15	3	08:33	Manual (1) <u>50</u> (2) _____ Check ok JDM/BJ 6.5v Counter (1) <u>50</u> (2) _____
4/22/15	4	08:26	Manual (1) <u>50</u> (2) _____ Check ok JDM/BJ 6.4v Counter (1) <u>50</u> (2) _____
4/23/15	5	<u>08:27</u>	Manual (1) <u>50</u> (2) _____ Check ok JDM/BJ 6.4v Counter (1) <u>50</u> (2) _____
4/24/15	6	<u>07:08</u>	Manual (1) <u>1</u> (2) _____ P/U ok JDM/BJ 6.4v Counter (1) <u>1</u> (2) _____

Sketch

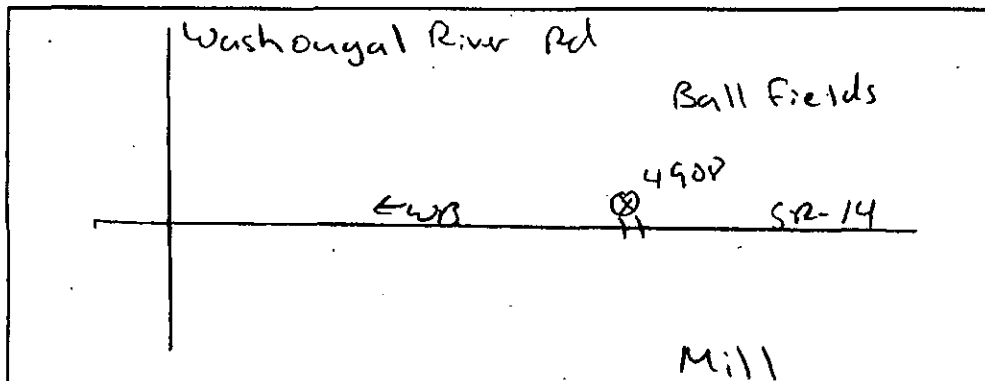

*J. Mydla*  
Field Person

*RU*

Interval  60 min.  15 min.  
 Binned(CL/SP)  Count(volume)  
Lane No  1  2  
  
Direction Channel 1 \_\_\_\_\_  
Direction Channel 2 \_\_\_\_\_  
Unique ID# \_\_\_\_\_

Counter No. 172294 Count ID HPMS  
SR 14 RRT/RRQ \_\_\_\_\_ MP 16.12  
  
Leg 2 Direction EB OSID \_\_\_\_\_

Station Description ON SR-14 E/O Washougal River rd wye conn

Date	Day	Time	Comments
4/20/15	2	11:34	Manual (1) <u>4</u> (2) _____ Set up ok JDM/BJ 6.5v Counter (1) <u>4</u> (2) _____
4/21/15	3	08:33	Manual (1) <u>31</u> (2) _____ Check ok JDM/BJ 6.5v Counter (1) <u>31</u> (2) _____
4/22/15	4	08:27	Manual (1) <u>31</u> (2) _____ Check ok JDM/BJ 6.4v Counter (1) <u>31</u> (2) _____
4/23/15	5	<u>08:28</u>	Manual (1) <u>25</u> (2) _____ Check ok JDM/BJ 6.4v Counter (1) <u>25</u> (2) _____
4/24/15	6	<u>07:08</u>	Manual (1) <u>1</u> (2) _____ P/U ok JDM/BJ <u>6.3v</u> Counter (1) <u>1</u> (2) _____

Sketch

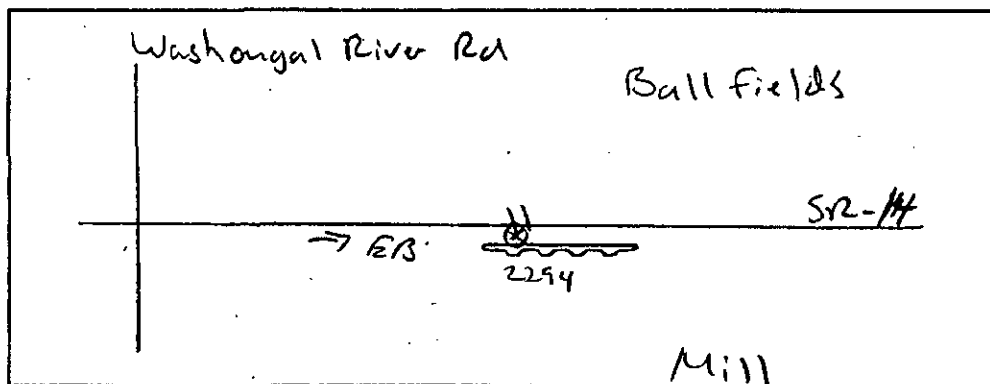

J. Mydler  
Field Person

STATE OF WASHINGTON - DEPARTMENT OF TRANSPORTATION  
 TRIP SYSTEM  
 HOURLY TRAFFIC CLASSIFICATION SUMMARY

SR 014 MP 016.12 OFF SYSTEM ID. LEG 2 DIRECTION OF TRAFFIC WESTBOUND LANE ALL OF  
 COUNT IDENTIFIER HPMS COUNTER NUMBER 174908 DESCRIPTION: ON SR 14 E/O WASHOUGAL RIVER RD WYE CONN

04-20-15	CARS PICKUPS	BUS	SINGLE MED	SINGLE UNITS HVY	4+ UNIT %	DOUBLE UNITS 4-5	DOUBLE UNITS 6+	DOUBLE UNIT %	5- TRAINS 6	7+ TRAINS 7+	TRAIN %	TRUCK %	CLASS UNKNOWN	TOTAL VEHICLES
12 - 1	477	3	12	3	3.8	6	15	5.8	1	2	.4	10.0		530
1 - 2	445	4	17	6	5.4	6	4	3.6		5	1.0	10.1	2	497
2 - 3	544	3	12	8	4.2	6	8	3.2		6	1.0	8.4		594
3 - 4	597	1	15	5	3.3	7	8	3.9		2	.5	7.6		646
4 - 5	613	1	20	3	3.6	5	10	3.5	1	1	.3	7.4		662
5 - 6	580		12	3	2.5	1	8	2.3		3	.7	4.8	1	609
6 - 7	407	1	10	1	2.8	2	3	.7				6.0		426
7 - 8	284	2	5		2.3	5	2	2.8		1	.5	5.5		302
8 - 9	206		3		2.3	1	3	2.8				4.9		218
9 - 10	137		3		2.1	3	1	2.5				3.8		144
10 - 11	77		1		1.3	1	1	2.5				10.0		80
11 - 12	45		1		2.0		2	8.0						50
AM TOTAL	4412	15	113	29	3.4	37	65	3.4	1	1	.5	7.2	3	4758
PM TOTAL	4412	15	113	29	3.4	37	65	3.4	1	1	.5	7.2	3	4758
DAY TOTAL	4412	15	113	29	3.4	37	65	3.4	1	1	.5	7.2	3	4758
														5081

2-AXLE EQUIVALENT

DOT-RNBS05A-8

STATE OF WASHINGTON - DEPARTMENT OF TRANSPORTATION  
TRIP SYSTEM  
HOURLY TRAFFIC CLASSIFICATION SUMMARY

DATE 04/29/15  
TIME 10:24:23  
PAGE 52

SR 014	MP 016.12	OFF SYSTEM ID.	COUNTER NUMBER	174908	DESCRIPTION: ON SR 14 E/O WASHOUGAL RIVER RD WYE CONN	LEG 2	DIRECTION OF TRAFFIC	WESTBOUND	LANE ALL OF							
04-21-15	TUESDAY	CARS	BUS	SINGLE MED	HVY	4+	SINGLE UNIT %	DOUBLE UNITS	DOUBLE UNIT %	5-	TRAINS	7+	TRAIN %	TRUCK %	CLASS UNKNOWN	TOTAL VEHICLES
AM HOURS	12	44	1	1	1	1	2.1	5	4.3	1	1	1	11.8	6.4	3	47
1	13	13	1	1	1	1	5.9	1	4.3	1	1	1	7.7	23.5	2	17
2	22	22	2	2	2	2	6.3	1	3.1	1	1	1	11.9	15.4	1	26
3	29	29	3	3	3	3	2.0	1	3.1	1	1	1	7.7	9.4	1	32
4	145	145	14	14	14	14	3.4	1	1.3	3	3	3	1.3	5.2	1	153
5	388	388	22	22	22	22	3.2	1	1.9	1	1	1	1.7	6.3	1	153
6	703	703	21	21	21	21	3.5	1	1.7	1	1	1	1.9	6.3	1	414
7	744	744	22	22	22	22	2.1	1	1.7	1	1	1	1.7	6.3	1	743
8	636	636	9	9	9	9	4.6	1	3.8	1	1	1	4.6	6.3	1	794
9	484	484	2	2	2	2	4.6	8	4.6	2	2	2	4.6	6.3	1	679
10	460	460	4	4	4	4	4.8	1	4.7	2	1	1	4.7	10.4	1	540
11	411	411	1	1	1	1	4.9	6	7.0	1	1	1	7.0	10.7	1	516
PM HOURS	12	431	1	1	1	1	4.8	8	4.8	1	1	1	4.8	13.1	1	474
1	482	482	2	2	2	2	5.5	8	4.6	1	1	1	4.6	10.0	1	479
2	489	489	3	3	3	3	3.8	5	4.6	1	1	1	4.6	11.1	1	542
3	532	532	2	2	2	2	3.6	2	2.3	2	2	2	2.3	6.9	1	525
4	594	594	2	2	2	2	4.8	14	4.0	2	2	2	4.0	8.0	1	578
5	586	586	2	2	2	2	3.1	4	3.2	1	1	1	3.2	8.5	1	650
6	434	434	5	5	5	5	1.1	4	1.8	2	2	2	1.8	5.5	1	620
7	232	232	7	7	7	7	2.9	5	2.2	1	1	1	2.2	4.1	1	451
8	207	207	8	8	8	8	4.0	1	3.1	2	2	2	3.1	4.1	1	242
9	130	130	1	1	1	1	4.0	5	2.2	1	1	1	2.2	8.0	1	225
10	57	57	1	1	1	1	2.0	1	1.7	1	1	1	1.7	3.7	1	135
11	46	46	1	1	1	1	2.0	2	5.9	1	1	1	5.9	1.7	1	58
AM TOTAL	4079	4079	9	111	30	10	3.6	19	3.4	6	4	31	3.4	8.0	2	4435
PM TOTAL	4220	4220	13	121	27	6	3.7	25	3.1	6	7	20	3.1	7.4	1	4556
DAY TOTAL	8299	8299	22	232	57	16	3.6	44	3.3	6	11	51	3.3	7.7	3	8991
2-AXLE EQUIVALENT																
9672																

SR 014 MP 016.12 OFF SYSTEM ID. LEG 2 DIRECTION OF TRAFFIC WESTBOUND LANE ALL OF  
 COUNT IDENTIFIER HPMS COUNTER NUMBER 174908 DESCRIPTION: ON SR 14 E/O WASHOUGAL RIVER RD WYE CONN

DATE	TIME	CARS PICKUPS	BUS	SINGLE MED	HVY	4+	SINGLE UNIT %	DOUBLE 4-	5	6+	DOUBLE UNIT %	5-	6	7+	TRAIN %	TRUCK %	CLASS UNKNOWN	TOTAL VEHICLES
04-22-15	WEDNESDAY	46		1			4.3				30.4					2.1		47
12	AM HOURS	14		1			4.5				12.2					39.1		23
1		19		1			4.9				30.4					17.1		22
2		34		1			2.2				1.3					8.8		41
3		124	1	3			3.9				1.1					5.1		136
4		710		14			3.6				2.7					6.1		748
5		803		18			3.0				2.7					5.4		855
6		803	5	10		2	2.3				3.9					9.0		688
7		651	2	14		1	3.9				6.7					12.3		557
8		507	2	13		2	4.8				7.4		2			12.3		480
9		421	3	12		1	3.9				7.4		2			12.3		457
10	PM HOURS	400	1	9		2	3.5				5.2					8.9		516
11		470	4	21		1	5.9				3.9					10.2		560
12		503	5	20		1	5.4				3.6					10.2		590
1		579	2	14			3.2				2.6					6.5		619
2		604	3	26			4.4				3.8					8.3		659
3		572	9	9		1	1.7				1.2					3.1		590
4		460	1	9			2.1				1.3					3.8		478
5		319	1	9			2.9				2.9					5.9		339
6		224		3			1.3				1.3					2.6		230
7		143		4			2.6				2.0					4.6		151
8		61		1			1.5				6.1					7.6		66
9		41		1			2.3				2.3					4.7		43
10																		
11																		
12																		
AM TOTAL		4087	14	113	21	6	3.5	17	78	63	3.6	5	4	26	.8	7.8		4434
PM TOTAL		4506	17	126	24	4	3.5	27	61	57	3.0	1	4	17	.4	6.9		4841
DAY TOTAL		8593	31	239	45	10	3.5	44	139	120	3.3	6	4	43	.6	7.3	1	9275

2-AXLE EQUIVALENT

DOT-RNB505A-8

STATE OF WASHINGTON - DEPARTMENT OF TRANSPORTATION  
TRIP SYSTEM  
HOURLY TRAFFIC CLASSIFICATION SUMMARY

DATE 06/29/15  
TIME 10:24:23  
PAGE 54

SR 014	MP 016.12	OFF SYSTEM ID.	COUNTER NUMBER	174908	DESCRIPTION: ON SR 14 E/O WASHOUGAL RIVER RD WYE CONN	LEG 2	DIRECTION OF TRAFFIC	WESTBOUND	LANE ALL OF								
04-23-15	THURSDAY																
AM HOURS		CARS PICKUPS	BUS	SINGLE MED	HVY	UNITS 4+	SINGLE UNIT %	DOUBLE UNITS 4-	DOUBLE UNITS 6+	DOUBLE UNIT %	5-	TRAINS 6	TRAINS 7+	TRAIN %	TRUCK %	CLASS UNKNOWN	TOTAL VEHICLES
12 - 1		48		1			2.0		1	3.9					5.9		51
1 - 2		11		1			7.7		1	7.7					15.4		13
2 - 3		23		1			3.1		1	15.6					9.4		28.1
3 - 4		38		2			4.9		1	3.9					2.4		7.3
4 - 5		141		3			2.0		3	1.3					1.3		41
5 - 6		370		16			4.1		2	3.9					1.0		152
6 - 7		709		24			3.5		2	1.0					4.8		390
7 - 8		793		18			2.5		5	2.1					5.6		745
8 - 9		657		11			3.1		5	4.1					8.0		840
9 - 10		499		2			4.4		17	3.5					8.9		715
10 - 11		447		1			5.2		8	4.8					10.7		548
11 - 12		434		3			4.9		10	4.9					10.6		500
PM HOURS																	486
12 - 1		453		20			5.9		7	3.6					10.7		507
1 - 2		421		15			6.6		8	3.8					10.0		468
2 - 3		490		16			4.4		13	5.0					9.8		543
3 - 4		563		20			4.1		16	4.5					8.8		617
4 - 5		603		19			3.4		8	2.9					6.8		647
5 - 6		531		18			3.6		2	1.6					5.5		562
6 - 7		360		12			3.4		3	2.4					5.8		382
7 - 8		207		3			1.8		6	4.1					5.9		220
8 - 9		198		6			2.8		5	3.7					7.5		214
9 - 10		113		3			2.5		2	2.5					5.0		119
10 - 11		81		3			1.2		2	3.5					5.8		86
11 - 12		57		1			1.2		1	1.7					1.7		58
AM. TOTAL		4170		128			3.7		62	3.1					7.6		4513
PM TOTAL		4077		133			3.9		73	3.4					7.8		4423
DAY TOTAL		8247		261			3.8		135	3.3					7.7		8936
																	9561

2-AXLE EQUIVALENT

STATE OF WASHINGTON - DEPARTMENT OF TRANSPORTATION  
TRIP SYSTEM  
HOURLY TRAFFIC CLASSIFICATION SUMMARY

SR 014 MP 016.12 OFF SYSTEM ID. LEG 2 DIRECTION OF TRAFFIC WESTBOUND LANE ALL OF

COUNT IDENTIFIER HPMS COUNTER NUMBER 174908 DESCRIPTION: ON SR 14 E/O WASHOUGAL RIVER RD WYE CONN

04-24-15 FRIDAY AM HOURS	CARS PICKUPS	BUS	SINGLE MED	UNITS HVV	4+	SINGLE UNIT %	DOUBLE UNITS	5	6+	DOUBLE UNIT %	5-	TRAINS 6	7+	TRAIN %	TRUCK %	CLASS UNKNOWN	TOTAL VEHICLES
12 - 1	52					7.7			1	1.9			1	1.9	3.7		54
1 - 2	22					4.5			2	7.7			2	9.1	15.4		26
2 - 3	17					4.3			1	9.1			2	22.7	22.7		22
3 - 4	40					4.3	1		4	10.6			2	14.9	14.9		47
4 - 5	126					4.5			1	1.5	1		2	2.3	5.3		133
5 - 6	315					3.3	1		3	1.4			1	.3	5.4		333
6 - 7	626						2		4				1		5.0		659
7 - 8																	
8 - 9																	
9 - 10																	
10 - 11																	
11 - 12																	
12 - 1																	
1 - 2																	
2 - 3																	
3 - 4																	
4 - 5																	
5 - 6																	
6 - 7																	
7 - 8																	
8 - 9																	
9 - 10																	
10 - 11																	
11 - 12																	
AM TOTAL	1198					3.5	4	9	11	1.9	1	1	6	.6	6.0		1274
PM TOTAL	1198					3.5	4	9	11	1.9	1	1	6	.6	6.0		1274
DAY TOTAL	1198					3.5	4	9	11	1.9	1	1	6	.6	6.0		1274

04-20-15 THRU 04-24-15  
AVERAGE WEEKDAY CLASSIFICATION VOLUMES  
\*\*\*\*\*  
CARS PICKUPS | BUS MED HVY | 4+ | SINGLE UNIT % | DOUBLE UNITS | 5- | TRAINS 6 | 7+ | TRAIN % | TRUCK % | CLASS UNKNOWN | TOTAL VEHICLES  
8380 | 25 | 244 | 49 | 13 | 3.7 | 47 | 136 | 113 | 3.3 | 6 | 8 | 45 | .7 | 7.6 | 2 | 9067  
3 DAYS | 91 | FACTOR GROUP P07 | 9339 |  
AVG WEEKDAY VOL | 9067 X SEASONAL ADJ. FACTOR 1.0300 = ESTIMATED AVG DAILY TRAFFIC | 9339

\*\*\*\*\*  
CARS PICKUPS | BUS MED HVY | 4+ | SINGLE UNIT % | DOUBLE UNITS | 5- | TRAINS 6 | 7+ | TRAIN % | TRUCK % | CLASS UNKNOWN | TOTAL VEHICLES  
8380 | 25 | 244 | 49 | 13 | 3.7 | 47 | 136 | 113 | 3.3 | 6 | 8 | 45 | .7 | 7.6 | 2 | 9067  
3 DAYS | 91 | FACTOR GROUP P07 | 9339 |  
AVG WEEKDAY VOL | 9067 X SEASONAL ADJ. FACTOR 1.0300 = ESTIMATED AVG DAILY TRAFFIC | 9339

DOT-RNB505A-8

STATE OF WASHINGTON - DEPARTMENT OF TRANSPORTATION  
TRIP SYSTEM  
HOURLY TRAFFIC CLASSIFICATION SUMMARY

DATE 06/29/15  
TIME 10:24:23  
PAGE 56

SR 014	MP 016.12	OFF SYSTEM ID.	LEG 2	DIRECTION OF TRAFFIC	EASTBOUND	LANE ALL OF													
COUNT IDENTIFIER	HPMS	COUNTER NUMBER	172294	DESCRIPTION:	ON SR 14 E/O WASHOUGAL RIVER RD WYE CONN														
04-20-15																			
MONDAY																			
AM HOURS	CARS PICKUPS	BUS	SINGLE MED	HVY	4+	SINGLE UNIT %	DOUBLE UNIT %	5-	TRAINS	6	7+	TRAIN %	TRUCK %	CLASS UNKNOWN	TOTAL VEHICLES				
12 -	1																		
1 -	2																		
2 -	3																		
3 -	4																		
4 -	5																		
5 -	6																		
6 -	7																		
7 -	8																		
8 -	9																		
9 -	10																		
10 -	11																		
11 -	12																		
PM HOURS																			
12 -	1																		
1 -	2																		
2 -	3																		
3 -	4																		
4 -	5																		
5 -	6																		
6 -	7																		
7 -	8																		
8 -	9																		
9 -	10																		
10 -	11																		
11 -	12																		
AM TOTAL	5669	17	203	26		4.0	50	98	40		3.1	1	6	21	.5	7.5	3	6134	
PM TOTAL	5669	17	203	26		4.0	50	98	40		3.1	1	6	21	.5	7.5	3	6134	
DAY TOTAL	5669	17	203	26		4.0	50	98	40		3.1	1	6	21	.5	7.5	3	6134	
																			6490

2-AXLE EQUIVALENT



SR 014	MP 016.12	OFF SYSTEM ID.	COUNTER NUMBER	172294	DESCRIPTION: ON SR 14 E/O WASHOUGAL RIVER RD WYE CONN	LEG 2	DIRECTION OF TRAFFIC	EASTBOUND	LANE ALL OF													
04-21-15	TUESDAY	CARS PICKUPS	BUS	SINGLE MED	HVY	4+	SINGLE UNIT %	DOUBLE UNITS	4-	5	6+	DOUBLE UNIT %	5-	TRAINS	6	7+	TRAIN %	TRUCK %	CLASS	UNKNOWN	VEHICLES	TOTAL
AM HOURS	12 - 1	55	1	4	3	1	4.0	1	1	3	1	5.1	1	1	1	1	2.2	6.8	1	1	59	59
	1 - 2	42		1			25.0					4.4					4.4	6.7			45	45
	2 - 3	24		1			4.5	4	4	5	1	4.5		1	1	1	1.7	4.0			25	25
	3 - 4	21	1	3	3	1	4.5	1	1	1	1	4.5		1	1	1	2.2	6.7			28	28
	4 - 5	80		11	1	1	7.6	10	10	9	1	7.3		1	1	1	1.1	10.1	1	1	89	89
	5 - 6	137		17	2	1	6.4	9	9	12	1	7.3		3	3	3	1.3	12.1	1	1	157	157
	6 - 7	269	5	21	5	2	7.8	7	7	9	1	6.4		2	2	2	1.2	15.4	1	1	313	313
	7 - 8	357	5	28	6	2	10.2	8	8	12	1	6.5		3	3	3	2.1	18.8	1	1	422	422
	8 - 9	312	3	24	5	3	8.8	17	17	4	1	7.3		2	2	2	1.5	17.5	1	1	384	384
	9 - 10	329	2	23	8	3	10.2	8	8	7	1	5.6		1	1	1	1.0	16.8	1	1	393	393
	10 - 11	327	6	30	5	1	9.3	10	12	8	1	7.1		1	1	1	.5	16.9	1	1	421	421
	11 - 12	350	3	30	5	1	10.4	9	6	12	1	5.7		2	2	2	1.5	17.6	1	1	472	472
PM HOURS	12 - 1	389	3	35	10	1	5.4	3	9	8	1	4.0		5	5	5	1.0	10.5	1	1	496	496
	1 - 2	443	4	19	4		4.6	7	7	14	1	5.1		4	4	4	.9	10.6			567	567
	2 - 3	507	2	20	4		4.9	4	4	6	1	2.7		2	2	2	.6	8.2			673	673
	3 - 4	618	2	27	4		5.1	5	6	6	1	1.9		1	1	1	.7	7.7			878	878
	4 - 5	810	4	38	3		3.5	5	7	8	2	2.2		1	1	1	.2	5.9			865	865
	5 - 6	814	2	30			3.3	2	2	5	2	1.6		3	3	3	.7	7.0			675	675
	6 - 7	628		33			3.1	3	3	3	1	.7					.9	4.4			453	453
	7 - 8	433		14			2.8	1	2	2	3	2.9					.9	3.7			351	351
	8 - 9	338	1	10			2.9	2	3	3	1	2.9					3.2	4.6			280	280
	9 - 10	267		4			1.8	1	1	1	1	2.9					3.2	6.4			172	172
	10 - 11	161		5			2.9	1	1	1	1	2.9					3.2	4.0			124	124
	11 - 12	119		1			1.8	4	4	4	1	3.2					.6	4.0			9448	9448
AM TOTAL		2303	20	162	35	13	8.4	46	71	55	1	6.3	2	6	21	1	1.1	15.8	1	1	2735	2735
PM TOTAL		5527	18	236	25	2	4.7	40	70	54	1	2.7	2	7	26	1	.5	8.0	1	1	6006	6006
DAY TOTAL		7830	38	398	60	15	5.8	86	141	109	2	3.8	2	13	47	2	.7	10.4	2	2	8741	8741
																			2-AXLE EQUIVALENT			9448

STATE OF WASHINGTON - DEPARTMENT OF TRANSPORTATION  
TRIP SYSTEM  
HOURLY TRAFFIC CLASSIFICATION SUMMARY

SR 014 MP 016.12 OFF SYSTEM ID. LEG 2 DIRECTION OF TRAFFIC EASTBOUND LANE ALL OF

COUNT IDENTIFIER HPMS COUNTER NUMBER 172294 DESCRIPTION: ON SR 14 E/O WASHOUGAL RIVER RD WYE CONN

DATE	TIME	CARS PICKUPS	BUS	SINGLE MED	HVY	4+	SINGLE UNIT %	DOUBLE 4-	5	6+	DOUBLE UNIT %	5-	6	7+	TRAIN %	TRUCK %	CLASS UNKNOWN	TOTAL VEHICLES
04-22-15	WEDNESDAY	48		2			3.7				5.6				1.9	11.1		54
12 -	AM HOURS	40		2			4.5				4.5					14.7		44
1 -		29		1			2.9	1			11.8					22.0		34
2 -		31		5			19.5				2.4					11.6	1	41
3 -		61	1	7			8.1				3.4					11.4		69
4 -		132	1	8			8.9				4.8					13.7		149
5 -		234	1	22			9.3	3			5.4					16.3		271
6 -		369	5	31			8.8	3			7.0					17.3		441
7 -		330	5	28			8.0	5			8.2					20.4		399
8 -		309	4	32			11.1	5			10.1	2				19.4		388
9 -		311	4	20			8.0	5			5.2	1				12.9		386
10 -		350	3	19			7.2	5								12.9		402
11 -	PM HOURS	420	3	22			6.8	10			7.8					15.5		497
12 -		450	4	26			6.2	9			5.6					13.3		519
1 -		539	5	26			5.8	9			4.0					10.8		604
2 -		721	5	35			4.9	2			2.2	1				7.7		781
3 -		768	3	45			5.9	4			1.7		1			7.9		834
4 -		794	2	19			2.4	3			.9					5.9		821
5 -		655	1	23			3.3	3			2.3					3.3		696
6 -		477	2	21			4.5	5			2.0					6.8		512
7 -		393	1	11			2.7	3			1.0					3.7		408
8 -		272	2	6			2.1	2			2.4					4.9	1	287
9 -		178	1	5			3.1	1			2.6					6.8		191
10 -		138		5			3.4	1			1.4					5.5		146
11 -		2244	19	177			8.8	26			6.4					16.2		2678
12 -	AM TOTAL	5805	17	245			4.5	49			2.8					7.8	1	6296
1 -	PM TOTAL	8049	36	422			5.8	75			3.9					10.3	2	8974
	DAY TOTAL														.7	2-AXLE EQUIVALENT		9683



SR 014 MP 016.12 OFF SYSTEM ID. LEG 2 DIRECTION OF TRAFFIC EASTBOUND LANE ALL OF  
COUNT IDENTIFIER HPMS COUNTER NUMBER 172294 DESCRIPTION: ON SR 14 E/O WASHOUGAL RIVER RD WYE CONN

04-24-15 FRIDAY AM HOURS	CARS PICKUPS	BUS	SINGLE MED	HVY	4+	SINGLE UNIT %	DOUBLE UNITS	6+	DOUBLE UNIT %	5- TRAINS	6 7+	TRAIN %	TRUCK %	CLASS UNKNOWN	TOTAL VEHICLES
12 - 1	75		3			3.7	3	1	4.9				8.5		82
1 - 2	46		1			2.0	2	2	4.1				6.1		49
2 - 3	32		2			5.4	1	1	8.1				13.5		37
3 - 4	34		4			14.0	2	1	7.0				20.9		43
4 - 5	72	2	3			7.3	3	5	3.7	1		1.2	12.2		82
5 - 6	117		10			8.7	1	5	4.3			2.2	15.2		138
6 - 7	215	3	20			10.7	5	8	6.5			.4	17.6		261
7 - 8															
8 - 9															
9 - 10															
10 - 11															
11 - 12															
PM HOURS															
12 - 1															
1 - 2															
2 - 3															
3 - 4															
4 - 5															
5 - 6															
6 - 7															
7 - 8															
8 - 9															
9 - 10															
10 - 11															
11 - 12															
AM TOTAL	591	5	43	10		8.4	16	18	5.5	1		.7	14.6		692
PM TOTAL															
DAY TOTAL	591	5	43	10		8.4	16	18	5.5	1		.7	14.6		692

04-20-15 THRU 04-24-15  
AVERAGE WEEKDAY CLASSIFICATION VOLUMES \*\*\*\*\*  
CARS PICKUPS | BUS MED HVY | 4+ | SINGLE UNIT % | DOUBLE UNITS | 5- | TRAINS 6 7+ | TRAIN % | TRUCK % | CLASS UNKNOWN | TOTAL VEHICLES  
7900 35 415 64 6 5.9 82 164 103 4.0 3 8 46 .6 10.5 2 8828  
TOTAL HOURS FOR COUNT 91 FACTOR GROUP P07  
3 DAYS 8828 X SEASONAL ADJ. FACTOR 1.0300 = ESTIMATED AVG DAILY TRAFFIC 9093  
AVG WEEKDAY VOL 8828 X SEASONAL ADJ. FACTOR 1.0300 = ESTIMATED AVG DAILY TRAFFIC 9093  
AVD 2-AXLE EQUIVALENT 9556

STATE OF WASHINGTON - DEPARTMENT OF TRANSPORTATION  
TRIP SYSTEM  
HOURLY TRAFFIC CLASSIFICATION SUMMARY

SR 014	MP 016.12	OFF SYSTEM ID.	LEG 2	DIRECTION OF TRAFFIC	BOTH WAYS	LANE ALL OF												
COUNT IDENTIFIER	HPMS	COUNTER NUMBER	172294	DESCRIPTION: ON SR 14 E/O WASHOUGAL RIVER RD WYE CONN														
04-20-15	MONDAY	CARS PICKUPS	BUS	SINGLE MED	UNITS HVY	4+	SINGLE UNIT %	DOUBLE UNITS 4-	5	6+	DOUBLE UNIT %	5-	TRAINS 6	7+	TRAIN %	TRUCK %	CLASS UNKNOWN	TOTAL VEHICLES
12	1	177		2	1		1.1				2.7			1	.5	4.3		185
10	11	242		3			1.6				1.6			2	.8	4.0		252
9	10	406		5			1.2				3.1			2	.4	4.2		549
8	9	524		10			1.8				2.0			2	.4	4.2		424
7	8	694	2	17			2.6	8	9	6	3.1			2	.4	5.7		736
6	7	1043	4	28	1		3.0	4	6	3	1.2	1		3	.4	4.6	1	1094
5	6	1375	1	36	4		2.8	5	11	7	1.6			2	.5	4.5		1440
4	5	1377	3	46	6		4.0	8	15	15	2.6	1		5	.5	6.9		1479
3	4	1278	7	46	10		5.1	13	20	16	3.5			3	.3	7.8		1386
2	3	1090	7	39	14	2	6.1	10	22	15	4.5			2	.6	11.7	3	1051
1	2	950	8	44	13		5.2	16	37	18	6.5			4	.6	12.4		1084
AM TOTAL	10081	32	316	55	4	4	3.7	87	163	98	3.2	2	7	41	.5	7.4	6	10892
PM TOTAL	10081	32	316	55	4	4	3.7	87	163	98	3.2	2	7	41	.5	7.4	6	10892
DAY TOTAL	10081	32	316	55	4	4	3.7	87	163	98	3.2	2	7	41	.5	7.4	6	10892
-----																		
2-AXLE EQUIVALENT																		
11571																		



SR 014	MP 016.12	OFF SYSTEM ID.	LEG 2	DIRECTION OF TRAFFIC	BOTH WAYS	LANE ALL OF							
COUNT IDENTIFIER	HPMS	COUNTER NUMBER	172294	DESCRIPTION: ON SR 14 E/O WASHOUGAL RIVER RD WYE CONN									
04-22-15													
WEDNESDAY													
AM HOURS	CARS PICKUPS	BUS	SINGLE MED	HVY	4+	SINGLE UNIT %	DOUBLE 4-5-6+	DOUBLE UNIT %	5-6-7+	TRAIN %	TRUCK %	CLASS UNKNOWN	TOTAL VEHICLES
12 - 1	94		2			2.0							101
1 - 2	54		3			4.5							67
2 - 3	48		2			3.6							56
3 - 4	65	1	6	3		12.2	1	4	3	1.0	6.9		67
4 - 5	185	1	10	4		3.4				1.5	19.5	1	82
5 - 6	490	1	22	3		5.1				3.6	14.3		205
6 - 7	944	1	48	6	2	5.0	2	7	3	2.9	9.8		529
7 - 8	1172	10	49	3	8	4.7	11	2	1	4.4	7.4		1019
8 - 9	981	5	38	6	12	5.2	8	15	1	3.3	9.6		1296
9 - 10	816	6	46	7	17	6.9	6	20	2	4.2	9.8		1087
10 - 11	732	5	33	12	4	6.2	8	36	1	5.7	13.7		945
11 - 12	750	4	31	10	2	5.5	8	26	2	8.2	15.5		866
PM HOURS													859
1 - 1	890	4	31	15	2	5.1	16	29	1	6.5	12.1		1013
1 - 2	953	8	47	9	1	6.0	13	20	1	4.7	11.7		1079
2 - 3	1069	10	46	10	1	5.6	12	17		3.8	10.5		1194
3 - 4	1300	2	49	7		4.1	5	14	1	2.4	7.1		1400
4 - 5	1372	5	71	2		5.2	10	16	1	2.6	8.1		1493
5 - 6	1115	1	28	1		2.1	4	6	1	1.0	3.2		1411
6 - 7	796	1	32			2.8	6	12	4	1.9	5.0		1174
7 - 8	617	3	30			3.9	4	12	2	2.4	6.5		851
8 - 9	415		14			2.2	2	2		1.1	3.3		638
9 - 10	239		10			2.3	2	5		2.3	4.8	2	438
10 - 11	179		7			2.7	1	3		3.5	7.0		257
11 - 12	179		6			3.2	1	2		1.6	5.3		189
AM TOTAL	6331	33	290	57	10	5.5	43	164	123	4.6	11.0		7112
PM TOTAL	10311	34	371	44	4	4.1	76	138	105	2.9	7.4		11157
DAY TOTAL	16642	67	661	101	14	4.6	119	302	228	3.6	8.8	3	18249
											2-AXLE EQUIVALENT		19608

SR 014	MP 016.12	OFF SYSTEM ID.	COUNTER NUMBER	172294	DESCRIPTION: ON SR 14 E/O WASHOUGAL RIVER RD WYE CONN	LEG 2	DIRECTION OF TRAFFIC	BOTH WAYS	LANE ALL OF								
04-23-15	THURSDAY																
AM HOURS																	
12 - 1		CARS PICKUPS	BUS	SINGLE MED	HVY	4+	SINGLE UNIT %	DOUBLE UNITS	DOUBLE UNIT %	5-	6	7+	TRAIN %	TRUCK %	CLASS UNKNOWN	VEHICLES	TOTAL
1 - 2		113	1	1			1.7	5	1.7					3.4		1	118
2 - 3		59		2			3.1	1	4.7	1				7.8			64
3 - 4		49		6			9.1	7	12.1	1				25.8			66
4 - 5		62		6	2		11.1	1	1.4	1				13.9			72
5 - 6		212	1	5	2		3.5	5	3.9	1				8.6			231
6 - 7		506	2	26	6		6.1	8	2.3	1				8.2			555
7 - 8		977	2	47	4		5.0	9	2.3	1				7.7			1059
8 - 9		1158	3	45	6	1	4.4	16	2.3	1				8.2			1262
9 - 10		925	1	45	6	2	5.3	9	5.3	2				11.4			1045
10 - 11		786	5	50	8	3	6.9	11	7.7	2				13.6			910
11 - 12		716	5	36	16	3	7.1	11	4.9	1				15.3			845
PM HOURS		787	7	39	19	3	7.5	6	4.9	1				13.0			905
12 - 1		826	4	44	10	3	6.5	10	4.9	1				12.6			945
1 - 2		842	7	43	15	1	6.8	13	6.0	1				13.6			974
2 - 3		1025	5	36	14		4.8	12	4.8	1				10.3			1143
3 - 4		1256	2	59	6		3.9	9	3.4	1				8.7			1375
4 - 5		1408	2	55	2		3.9	13	2.7	2				7.1			1515
5 - 6		1289	3	45	1		4.3	10	1.5					5.4			1362
6 - 7		967	3	42	1		4.3	6	2.5					6.8			1038
7 - 8		666	2	14			2.3	4	3.0					5.4			704
8 - 9		583		20			3.2	3	3.0					6.6			624
9 - 10		393		13			3.1	4	1.4					5.1			414
10 - 11		279		6			2.1	3	1.7					4.1			291
11 - 12		184		2			1.1	2	1.1					2.1			188
AM TOTAL		6350	27	308	70	9	5.8	55	4.3	6				10.9			7132
PM TOTAL		9718	27	379	49	4	4.3	83	3.3	4				8.1			10573
DAY TOTAL		16068	54	687	119	13	4.9	138	3.7	10				9.2			17705
														2-AXLE EQUIVALENT	3		19037



STATE OF WASHINGTON - DEPARTMENT OF TRANSPORTATION  
 TRIP SYSTEM  
 HOURLY TRAFFIC CLASSIFICATION SUMMARY

SR 014 MP 016.12 OFF SYSTEM ID. LEG 2 DIRECTION OF TRAFFIC BOTH WAYS LANE ALL OF  
 COUNT IDENTIFIER HPMS COUNTER NUMBER 172294 DESCRIPTION: ON SR 14 E/O WASHOUGAL RIVER RD WYE CONN

04-24-15	CARS PICKUPS	BUS MED	SINGLE HVY	4+	SINGLE UNIT %	DOUBLE UNITS	6+	DOUBLE UNIT %	5-	6	7+	TRAIN %	TRUCK %	CLASS UNKNOWN	TOTAL VEHICLES
FRIDAY	127	3	1	2.2	4-	5	1	3.7	1	1	1	.7	6.6		136
AM HOURS	68	2	3	4.0	2	2	2	5.3			2	3.4	9.3		75
1 -	49	3	2	5.1	2	2	1	8.5			2	3.4	16.9		59
2 -	74	6	2	8.9	3	5	1	8.9			3	1.9	17.8		90
3 -	198	2	5	3.7	3	1	1	2.3	1		3	1.9	7.9		215
4 -	432	24	3	5.7	2	5	2	1.9			2	.6	8.3		471
5 -	841	41	6	5.4	7	11	8	2.8	1	1	2	.3	8.6		920
6 -															
7 -															
8 -															
9 -															
10 -															
11 -															
12 -															
AM TOTAL	1789	5	84	13	5.2	20	27	15	3.2	2	1	10	.7		1966
PM TOTAL	1789	5	84	13	5.2	20	27	15	3.2	2	1	10	.7		1966
DAY TOTAL	1789	5	84	13	5.2	20	27	15	3.2	2	1	10	.7		1966

04-20-15 THRU 04-26-15

AVERAGE WEEKDAY CLASSIFICATION VOLUMES \*\*\*\*\*

AVERAGE WEEKDAY	CARS PICKUPS	BUS MED	SINGLE HVY	4+	SINGLE UNIT %	DOUBLE UNITS	6+	DOUBLE UNIT %	5-	6	7+	TRAIN %	TRUCK %	CLASS UNKNOWN	TOTAL VEHICLES
AVERAGE WEEKDAY	16280	60	659	112	19	4.7	129	299	216	3.6	9	15	9.1	.6	17895
TOTAL HOURS FOR COUNT															19249
3 DAYS															
AVG WEEKDAY VOL	17895	X	SEASONAL ADJ.	FACTOR	1.0300	=	ESTIMATED	AVG	DAILY	TRAFFIC	18432				

PEAK HOUR PERCENTAGES: K = 8.54 O = 57.46 T = 8.05  
 VOLUME = 1528 DATE: 04/21/15 TIME: 04:00 PM

NOTE: MED HIGH EB/COUNT HIGH?